

TABLE OF CONTENTS

Introduction

Features and Benefits Summary	2
Terminal Configurations	3

Specifications

Battery Specifications (applies to Platinum O.E. version only)	4-8
Battery Upgrade Cross Reference Chart	9-10

Applications

Motorcycle Battery Applications	11-16
Scooter Applications	16-17
Utility Vehicle Applications	17
All Terrain Vehicle Applications	18-19
Personal Watercraft Applications	19-20
Snowmobile Applications	20-21
European and Other Motorcycle Battery Applications	21-23
Riding Mower Applications	24
12 Volt Import Specialty Battery Specifications	25
Japanese Tractor Battery Applications	25

Battery Information

Top 25 Batteries	26
Activating High Performance Conventional (YB Type) and Conventional Batteries (6N & 12N Types)	27
Battery Maintenance for 6N, 12N & YB Types	27
Activation and Charging Maintenance Free VRLA Batteries (YT & YI Types)	28

DISCLAIMER

The replacement battery information published in this book has been obtained from the equipment manufacturers listed, except as otherwise noted. Users are cautioned that the information contained in this book was the most current information provided to us at the time of publication. The information is subject to change upon notice from equipment manufacturers or field experience. Users should use the most current edition of the Motorcycle Battery Replacement Data Book. Motorcycle Products Company expressly denies any responsibility for the accuracy provided to us. While we have made every effort to accurately catalog the replacement battery information contained in this book, Motorcycle Products Company denies any liability for damages as a consequence of using the information in this book. Users should also attempt to obtain replacement battery information from the equipment manufacturer's user manual or service department for their specific application.

FEATURES AND BENEFITS

Component	Features	Benefits
Cast Grid	Special Grid Design	Severe vibration resistance & improved conductivity
Active Material	Proprietary Formulation	Reduced shedding, maximum utilization, & long service life
Pasted Plates	Specified Thickness & Weight	Ensures vibration resistance through precise compression & proper service life through specified active material balance
Dried-Charged Plates	Tank Formed & Dried Plates	Properly dried plates in a sealed battery have a virtually limitless shelf-life, while still retaining 70-80% state of charge when initially filled with acid
Top Lead Connections	Through-Partition Construction, Large Straps	Shorter current path for increased electrical conductivity & higher starting currents, heavier parts for maximum durability
Case-Cover Seal	Thermal Bonded Plastic	Air tight seal to prevent air ingress & acid seepage
Terminal- Cover Seal	Patented Poly-Seal Terminal	Eliminates acid seepage, reduces corrosion, & extends battery life
Case & Cover	Polypropylene	Superior resistance to gasoline & oil, impact resistant in extreme weather conditions
Additive	Sulfate Stop (Some models)	Sulfate stop added to reduce the solubility of lead into the acid, which then reduces battery sulfation potential
YuMicron		
Separator	Leaf or Envelope Separator	Polyethylene with glass mat sheet bonded for compression to withstand severe vibration conditions
YTX		
Separator	Absorbed Glass Mat	Absorbs acid while creating cell compression for extreme vibration resistance
Top Lead Alloy	Calcium Alloy	Increased weld strength & severe vibration resistance
Vent System	Valve & Flame Arrestor	Valve relieves excess pressure to prevent bursting, flame arrestor frit prevents internal combustion
High Performance Maintenance Free		
Grid System	Computer-Designed Radial Grids	Increased conductivity for higher starting wattage, increased vibration resistance
Separator	Puncture Resistant AGM Material	High puncture resistant separator for increased service in high vibration applications

TERMINAL CONFIGURATIONS

Terminal shapes vary from one battery to another. By identifying the correct replacement battery from the listing in this book, you are assured of the proper terminal configuration. For custom applications, refer to the following chart to identify terminal shape and corresponding batteries.

Terminal				Battery Type							
Type	Front	Side	Top								
1				YB14L-A1 YTX16-BS-1							
2				YB9L-A2 12N5.5-4A		YB16AL-A2					
3				YB7C-A 12N24-3		Y60-N24AL-B 12N24-3A		Y60-N24-A			
4				YB12C-A YTX14L-BS YTX20CH-BS YTX20HL-BS-PW		YB16B-A YTX14H-BS YTX20-BS YTX24HL-BS		Y50-N18L-A3 YTX14AH-BS YTX20L-BS GYZ20L		YB30L-B YTX14AHL-B YTX20H-BS	YB30CL-B YTX15L-BS YTX20HL-BS
5				YTX4L-BS YTX9-BS YTX16-BS YB4L-A		YTX5L-BS YT12A-BS YB4L-B		YTZ7S YTX12-BS YB16C-B		YTX7A-BS KMX14-BS YB16CL-B	YTX7L-BS YTX14-BS YIX30L
6				YB3L-A YB7L-B YB12A-A YB16-B-CX 12N5-3B 12N7-4A 12N9-4B-1 6N6-3B B39-6		YB3L-B YB9A-A YB12AL-A YB16L-B 12N5-4B 12N7-4B 12N10-3A 6N6-3B-1 B54-6		YB5L-B YB9-B YB12A-B YB16HL-A-CX 12N5.5-3B 12N7D-3B 12N10-3A-1 6N11A-1B B38-6A		YB7-A YB9L-B YB14A-A1 SYB16L-B 12N9-3A-1 12N12A-4A-1 6N11-2D	YB7B-B YB10L-B YB16-B 12N7-3B 12N9-3B 6N12A-2D
7				HYB16A-AB Y50-N18A-A		YB16B-A1** Y50-N18L-A		YB18-A Y50-N18L-A-CX		YB18L-A SY50-N18L-AT	
8				YB10A-A2 YB12B-B2 SYB14L-A2 12N10-3A-2		YB10L-A2 YB14-A2 YB14-B2 12N11-3A-1		YB10L-B2 YB14A-A2 YB14L-B2 12N14-3A		YB12AL-A2* YB14L-A2	
9				YHD-12H 12N9-3A							
10				51814		51913		53030			
11				YT9B-BS YT7B-BS		YTZ10S YTR9-BS		YTZ12S YT12B-B		YTZ14S	YT14B-BS
12				YTR4A-BS							
13				YT4B-BS							

** Includes **terminal adapter** converting to side mount.

* Includes **terminal adapter** converting to top mount.

HIGH PERFORMANCE MAINTENANCE FREE (AGM) Battery Specifications 12 VOLT

PART NO. W/ACID PACK	PART NO. FACTORY ACTIVATED	BATTERY TYPE		CAPACITY AH (10H-R)	DIMENSIONS – INCHES (± 1/16 IN)			DIMENSIONS – MILLIMETERS (± 2 MM)			ASSEMBLY FIGURE (AS PER COVER POLARITY)	WEIGHT W/O ACID (LBS)	TERMINAL TYPE (REFER TO PAGE 3)	ACID VOLUME (LITER)	REGULAR CHARGE CURRENT (AMP)	C.C.A. @ 0°F (-18°C)
					L	W	H	L	W	H						
M62H4A	M72H4A	YTX14AH-BS †††	FA	12	5 5/16	3 1/2	6 9/16	134	89	166		9.0	4	0.66	1.2	210
M62H4L	M72H4L	YTX14AHL-BS	FA	12	5 5/16	3 1/2	6 9/16	134	89	166		9.0	4	0.66	1.2	210
M6RH4H	-	YTX14H-BS	FA	12	6	3 7/16	5 3/4	150	87	145		8.8	4	0.69	1.2	260
M6220C	-	YTX20CH-BS		18	6	3 7/16	6 3/8	150	87	161		11.0	4	0.82	1.8	270
M62RBH	M72RBH	YTX20H-BS	FA	18	6 7/8	3 7/16	6 1/8	175	87	155		12.4	4	0.93	1.8	310
M620BH	M720BH	YTX20HL-BS	FA	18	6 7/8	3 7/16	6 1/8	175	87	155		12.4	4	0.93	1.8	310
M620BH-PW	M720BH-PW	YTX20HL-BS-PW	FA	18	6 7/8	3 7/16	6 7/8 §	175	87	175 §		12.4	4	0.93	1.8	310
M6250H	M7250H	YTX24HL-BS	FA	21	8 1/8	3 7/16	6 3/8	205	87	162		14.4	4	0.99	2.1	350
M6230X	-	YIX30L-BS	FA	30	6 9/16	5	6 7/8	166	126	175		22.0	5	1.40	3.0	385

FACTORY ACTIVATED MAINTENANCE FREE (AGM) Battery Specifications 12 VOLT

PART NO. W/ACID PACK	BATTERY TYPE	CAPACITY AH (10H-R)	DIMENSIONS – INCHES (± 1/16 IN)			DIMENSIONS – MILLIMETERS (± 2 MM)			ASSEMBLY FIGURE (AS PER COVER POLARITY)	WEIGHT WITH ACID (LBS)	TERMINAL TYPE (REFER TO PAGE 3)	ACID VOLUME (LITER)	REGULAR CHARGE CURRENT (AMP)	C.C.A. @ 0°F (-18°C)
			L	W	H	L	W	H						
M727ZS	YTZ7S	6	4 7/16	2 3/4	4 1/8	113	70	105		4.6	5	N/A	0.6	130
M7210A	YTZ10S	8.6	6	3 7/16	3 11/16	150	87	93		7.0	11	N/A	0.9	190
M7212A	YTZ12S	11	6	3 7/16	4 3/8	150	87	110		8.1	11	N/A	1.1	210
M72Z14	YTZ14S	11.2	6	3 7/16	4 3/8	150	87	110		8.6	11	N/A	1.1	230

MAINTENANCE FREE (AGM) Battery Specifications 12 VOLT

PART NO. W/ACID PACK	PART NO. FACTORY ACTIVATED	BATTERY TYPE		CAPACITY AH (10H-R)	DIMENSIONS – INCHES (± 1/16 IN)			DIMENSIONS – MILLIMETERS (± 2 MM)			ASSEMBLY FIGURE (AS PER COVER POLARITY)	WEIGHT W/O ACID (LBS)	TERMINAL TYPE (REFER TO PAGE 3)	ACID VOLUME (LITER)	REGULAR CHARGE CURRENT (AMP)	C.C.A. @ 0°F (-18°C)
					L	W	H	L	W	H						
M62T4B	-	YT4B-BS		2.3	4 1/2	1 9/16	3 7/16	114	39	86.5		2.1	13	0.12	0.3	40
M62X4B	-	YTX4L-BS		3	4 1/2	2 13/16	3 3/8	114	71	86		2.9	5	0.18	0.4	50
M32X5B	-	YTX5L-BS		4	4 1/2	2 13/16	4 3/16	114	71	106		3.5	5	0.24	0.5	70
M62T7B	-	YT7B-BS		6.5	6	2 9/16	3 11/16	150	65	93		5.0	11	0.33	0.7	85
M32X7A	-	YTX7A-BS		6	6	3 7/16	3 3/4	150	87	94		5.3	5	0.33	0.7	90
M327BS	-	YTX7L-BS		6	4 1/2	2 13/16	5 3/16	114	71	131		5.1	5	0.33	0.6	85
M62R9B	-	YT9B-BS		8	6	2 3/4	4 1/8	150	70	105		7.5	11	0.40	0.8	115
M329BS	M429BS	YTX9-BS	FA	8	6	3 7/16	4 3/16	150	87	105		5.4	5	0.40	0.9	120
M32ABS	-	YT12A-BS		9.5	6	3 7/16	4 3/16	150	87	105		6.3	5	0.47	1.0	175
M6212B	-	YT12B-BS		10	6	2 3/4	5 1/8	150	69	130		7.6	11	0.52	1.0	125
M3RH2S	M4RH2S	YTX12-BS	FA	10	6	3 7/16	5 1/8	150	87	130		7.5	5	0.60	1.2	180
M624B4	-	YT14B-BS		12	6 1/8	2 3/4	5 3/4	150	70	145		10.1	11	0.60	1.2	210
M3RH4L	-	YTX14L-BS		12	6	3 7/16	5 3/4	150	87	145		8.1	5	0.69	1.4	200
M6215L	-	YTX15L-BS		13	6 7/8	3 7/16	5 1/8	175	87	130		8.8	4	0.69	1.3	230
M32X6S	-	YTX16-BS		14	6	3 7/16	6 3/8	150	87	161		10.3	4	0.78	1.4	230
M32X61	-	YTX16-BS-1		14	6	3 7/16	6 3/8	150	87	161		10.3	1	0.78	1.4	230
M32RBS	M42RBS	YTX20-BS	FA	18	6 7/8	3 7/16	6 1/8	175	87	155		11.2	4	0.93	1.8	270
M320BS	M4220BS	YTX20L-BS	FA	18	6 7/8	3 7/16	6 1/8	175	87	155		11.2	4	0.93	1.8	270

FA Also available Factory Activated. Drop “-BS” from part no.

††† Includes 10mm spacer for additional height required in replacing YB14A-A1 and YB14A-A2.

§ Height with 20mm spacer included for use in replacing YB16CL-B.

PLATINUM O.E.

HIGH PERFORMANCE CONVENTIONAL

Battery Specifications

12 VOLT

DRY PART NO. (opt.)	PART NO. W/ACID PACK (std.)	BATTERY TYPE	CAPACITY AH (10H-R)	DIMENSIONS - INCHES (± 1/16 IN)			DIMENSIONS - MILLIMETERS (± 2 MM)			ASSEMBLY FIGURE (AS PER COVER POLARITY)	WEIGHT W/O ACID (LBS)	TERMINAL TYPE (REFER TO PAGE 3)	ACID VOLUME (OZ)	REGULAR CHARGE CURRENT (AMP)
				L	W	H	L	W	H					
M225LC	M325LC	YB2.5L-C	2.5	3 3/16	2 3/4	4 1/8	80	70	105		1.7	-	8.1	0.3
M22LC1	M32LC1	YB2.5L-C-1	2.5	3 3/16	2 3/4	4 1/8	80	70	105		1.7	-	8.1	0.3
M223LA	M323LA	YB3L-A	3	3 7/8	2 1/4	4 3/8	98	56	110		2.5	6	8.1	0.3
M223LB	-	YB3L-B	3	3 7/8	2 1/4	4 3/8	98	56	110		2.5	6	8.1	0.3
M224LA	-	YB4L-A	4	4 3/4	2 3/4	3 5/8	120	70	92		2.8	5	10.1	0.4
M224LB	M324LB	YB4L-B	4	4 3/4	2 3/4	3 5/8	120	70	92		2.8	5	10.1	0.4
M225LB	M325LB	YB5L-B	5	4 3/4	2 3/8	5 1/8	120	60	130		3.5	6	12.2	0.5
M227AY	-	YB7-A	8	5 5/16	3	5 1/4	135	75	133		5.1	6	20.3	0.8
M227BB	-	YB7B-B	7	6	2 3/8	5 1/8	150	60	130		4.0	6	16.9	0.7
M227CY	-	YB7C-A	8	5 1/8	3 9/16	4 1/2	130	90	114		5.1	3	20.3	0.8
M2273Y	-	YB7L-B	8	5 5/16	3	5 1/4	135	75	133		5.1	6	20.3	0.8
M229AY	M329AY	YB9A-A	9	5 5/16	3	6 1/8	135	75	155		5.3	6	20.3	0.9
M2292Y	-	YB9L-A2	9	5 5/16	3	5 1/2	135	75	139		5.3	2	20.3	0.9
M229BY	M329BY	YB9-B	9	5 5/16	3	5 1/2	135	75	139		5.3	6	20.3	0.9
M229LY	M329LY	YB9L-B	9	5 5/16	3	5 1/2	135	75	139		5.3	6	20.3	0.9
M221AY	M321AY	YB10A-A2	11	5 5/16	3 9/16	6 1/8	135	90	155		7.0	8	27.0	1.1
M2210Y	M3210Y	YB10L-A2	11	5 5/16	3 9/16	5 3/4	135	90	145		7.0	8	27.0	1.1
M221LB	M321LB	YB10L-B	11	5 5/16	3 9/16	5 3/4	135	90	145		7.0	6	27.0	1.1
M221L2	-	YB10L-B2	11	5 5/16	3 9/16	5 3/4	135	90	145		7.0	8	27.0	1.1
M2212Y	M3212Y	YB12A-A	12	5 5/16	3 3/16	6 5/16	134	80	160		6.8	6	27.0	1.2
M22S2Y	M32S2Y	YB12A-A W/S †	12	5 5/16	3 3/16	6 5/16	134	80	160		6.8	6	27.0	1.2
M2212T	-	YB12A-A W/TA **	12	5 5/16	3 3/16	6 5/16	134	80	160		6.8	6	27.0	1.2
M2221T	-	YB12AL-A W/TA D	12	5 5/16	3 3/16	6 5/16	134	80	160		6.8	6	25.4	1.2
M2221Y	M3221Y	YB12AL-A	12	5 5/16	3 3/16	6 5/16	134	80	160		6.8	6	25.4	1.2
M22212	-	YB12AL-A2 *	12	5 5/16	3 3/16	6 5/16	134	80	160		6.8	8	25.4	1.2
M222AB	-	YB12A-B	12	5 5/16	3 3/16	6 5/16	134	80	160		6.8	6	25.4	1.2
M221B2	-	YB12B-B2	12	6 5/16	3 9/16	5 1/8	160	90	130		7.1	8	27.0	1.2
M222CA	-	YB12C-A	12	5 5/16	3 3/16	6 7/8	134	80	175		7.1	4	27.0	1.2
M2214H	M3214H	YB14-A2	14	5 5/16	3 1/2	6 9/16	134	89	166		7.6	8	30.4	1.4

† When ordering this battery, specify sensor
 * Includes **terminal adaptor** converting to top mount
 ** When ordering this battery, specify **terminal adaptor**
D Discontinued, use YB12AL-A2

PLATINUM O.E.

HIGH PERFORMANCE CONVENTIONAL

Battery Specifications

12 VOLT (CONT.)

DRY PART. NO. (opt.)	PART NO. W/ACID PACK (std.)	BATTERY TYPE	CAPACITY AH (10H-R)	DIMENSIONS - INCHES (± 1/16 IN)			DIMENSIONS - MILLIMETERS (± 2 MM)			ASSEMBLY FIGURE (AS PER COVER POLARITY)	WEIGHT W/O ACID (LBS)	TERMINAL TYPE (REFER TO PAGE 3)	ACID VOLUME (OZ)	REGULAR CHARGE CURRENT (AMP)
				L	W	H	L	W	H					
M224A1	M324A1	YB14A-A1	14	5 5/16	3 1/2	6 15/16	134	89	176		7.9	6	30.4	1.4
M2214A	M3214A	YB14A-A2	14	5 5/16	3 1/2	6 15/16	134	89	176		7.9	8	30.4	1.4
M22141	-	YB14L-A1	14	5 5/16	3 1/2	6 9/16	134	89	166		7.6	1	30.4	1.4
M2214Y	M3214Y	YB14L-A2	14	5 5/16	3 1/2	6 9/16	134	89	166		7.6	8	30.4	1.4
M22S4Y	M32S4Y	YB14L-A2 W/S †	14	5 5/16	3 1/2	6 9/16	134	89	166		7.6	8	30.4	1.4
M2214B	-	YB14L-B2	14	5 5/16	3 1/2	6 9/16	134	89	166		7.6	8	30.4	1.4
M224B2	-	YB14-B2	14	5 5/16	3 1/2	6 9/16	134	89	166		7.6	8	30.4	1.4
M2214S	-	SYB14L-A2 #	14	5 5/16	3 1/2	6 9/16	134	89	166		7.6	8	30.4	1.4
M22B4S	-	SYB14L-B2 #D1	14	5 5/16	3 1/2	6 9/16	134	89	166		7.6	8	30.4	1.4
M22162	M32162	YB16AL-A2	16	8 1/8	2 13/16	6 7/16	207	71.5	164		8.6	2	37.2	1.6
M22H6B	M32H6B	HYB16A-AB	16	6	3 5/8	7 1/16	151	91	180		8.5	7	30.4	1.6
M2216Y	M3216Y	YB16-B	19	6 7/8	4	6 1/8	175	100	155		10.5	6	40.6	1.9
M2216C	M3216C	YB16-B-LM	19	6 7/8	4	6 1/8	175	100	155		10.5	6	40.6	1.9
M2216K	M3216K	YB16L-B	19	6 7/8	4	6 1/8	175	100	155		10.5	6	40.6	1.9
M2H16C	M3H16C	YB16HL-A-LM	19	6 7/8	4	6 1/8	175	100	155		10.5	6	40.6	1.9
M2216B	-	YB16B-A	16	6 5/16	3 9/16	6 3/8	160	90	161		8.4	4	33.8	1.6
M22161	-	YB16B-A1 *	16	6 5/16	3 9/16	6 3/8	160	90	161		8.4	7	33.8	1.6
M226CB	M326CB	YB16C-B	19	6 7/8	4	6 7/8	175	100	175		10.1	5	40.6	1.9
M226CB	M326CB	YB16CL-B	19	6 7/8	4	6 7/8	175	100	175		10.1	5	40.6	1.9
M22S6A	-	SYB16L-B # D2	19	6 15/16	4	6 1/8	175	100	155		9.3	6	43.9	1.9
M2281Y	M3281Y	YB18-A	18	7 1/8	3 9/16	6 3/8	180	90	162		9.4	7	40.6	1.8
M2218L	M3218L	YB18L-A	18	7 1/8	3 9/16	6 3/8	180	90	162		9.4	7	40.6	1.8
M228AY	-	Y50-N18A-A	20	8 1/8	3 9/16	6 15/16	205	90	176		11.2	7	50.7	2.0
M2218Y	M3218Y	Y50-N18L-A	20	8 1/8	3 9/16	6 3/8	205	90	162		11.2	7	47.3	2.0
M2218C	M3218C	Y50-N18L-A-LM	20	8 1/8	3 9/16	6 3/8	205	90	162		11.2	7	47.3	2.0
M228A3	M328A3	Y50-N18L-A3	20	8 1/8	3 9/16	6 3/8	205	90	162		11.2	4	47.3	2.0
M22S8T	-	SY50-N18L-AT #	20	8 1/8	3 9/16	6 3/8	205	90	162		11.2	7	47.3	2.0
M2224A	-	Y60-N24-A	28	7 1/4	4 7/8	6 7/8	184	124	175		14.4	3	57.5	2.8
M2224B	-	Y60-N24AL-B D3	28	7 1/4	4 7/8	6 7/8	184	124	175		14.4	3	57.5	2.8
M22H30	-	YB30L-B	30	6 5/8	5 3/16	6 15/16	168	132	176		14.1	4	57.5	3.0
M2230C	-	YB30CL-B	30	6 5/8	5 3/16	7 9/16	168	132	192.2		14.5	4	57.5	3.0
M2219B	-	51814	19***	7 7/16	3 1/4	6 7/8	186	82	171		9.4	10	33.8	1.9
M2219A	-	51913	19***	7 7/16	3 1/4	6 7/8	186	82	171		9.4	10	33.8	1.9
M2230B	-	53030	30***	7 7/16	5 1/8	6 7/8	186	130	171		16.1	10	54.1	3.0

† When ordering this battery, specify sensor
 # This battery includes a **sensor**
 * Includes **terminal adaptor** converting to top mount
 *** @ 20 hr. rate

D1 Discontinued, use YB14L-B2
D2 Discontinued, use YB16L-B
D3 Discontinued, use 53030

PLATINUM O.E. CONVENTIONAL Specifications

12 VOLT

DRY PART NO. (opt.)	PART NO. W/ACID PACK (std.)	BATTERY TYPE	CAPACITY AH (10H-R)	DIMENSIONS - INCHES (± 1/16 IN)			DIMENSIONS - MILLIMETERS (± 2 MM)			ASSEMBLY FIGURE (AS PER COVER POLARITY)	WEIGHT W/O ACID (LBS)	TERMINAL TYPE (REFER TO PAGE 3)	ACID VOLUME (OZ)	REGULAR CHARGE CURRENT (AMP)
				L	W	H	L	W	H					
M2253B	M3253B	12N5-3B	5	4 3/4	2 3/8	5 1/8	120	60	130		3.1	6	13.5	0.5
M2250B	M3250B	12N5-4B	5	4 3/4	2 3/8	5 1/8	120	60	130		3.1	6	13.5	0.5
M2255B	M3255B	12N5.5-3B	5.5	5 5/16	2 3/8	5 1/8	135	60	130		4.3	6	13.5	0.6
M2254A	M3254A	12N5.5-4A	5.5	5 5/16	2 3/8	5 1/8	135	60	130		4.3	2	13.5	0.6
M22A5B	M32A5B	12N5.5A-3B	5.5	4 1/16	3 9/16	4 1/2	103	90	114		4.3	6	16.9	0.6
M2273B	M3273B	12N7-3B	7	5 5/16	3	5 1/4	135	75	133		4.9	6	16.9	0.7
M2274A	M3274A	12N7-4A	7	5 5/16	3	5 1/4	135	75	133		4.9	6	16.9	0.7
M2270B	M3270B	12N7-4B	7	5 5/16	3	5 1/4	135	75	133		4.9	6	16.9	0.7
M227DB	-	12N7D-3B	7	5 5/16	3	5 15/16	135	75	150		4.9	6	20.3	0.7
M2293A	-	12N9-3A	9	5 5/16	3	5 1/2	135	75	139		5.4	9	20.3	0.9
M22931	-	12N9-3A-1 D4	9	5 5/16	3	5 1/2	135	75	139		5.4	6	20.3	0.9
M2293B	M3293B	12N9-3B	9	5 5/16	3	5 1/2	135	75	139		5.4	6	20.3	0.9
M2290B	M3290B	12N9-4B-1	9	5 5/16	3	5 1/2	135	75	139		5.4	6	20.3	0.9
M2210A	-	12N10-3A D5	10	5 5/16	3 9/16	5 3/4	135	90	145		6.4	6	27.0	1.0
M22101	-	12N10-3A-1 D5	10	5 5/16	3 9/16	5 3/4	135	90	145		6.4	6	27.0	1.0
M22102	-	12N10-3A-2	10	5 5/16	3 9/16	5 3/4	135	90	145		5.8	8	27.0	1.0
M2211B	M3211B	12N11-3A-1	11	5 5/16	3 9/16	6 1/8	135	90	155		7.5	8	27.0	1.1
M2221B	M3221B	12N12A-4A-1	12	5 5/16	3 3/16	6 5/16	134	80	160		6.8	6	23.7	1.2
M2241B	M3241B	12N14-3A	14	5 5/16	3 1/2	6 9/16	134	89	166		7.5	8	27.0	1.4
M22240	-	12N24-3	24	7 1/4	4 7/8	6 7/8	184	124	175		12.1	3	40.6	2.4
M22H12	M32H12	YHD-12H	29	8 1/8	5 1/4	6 1/2	206	133	165		13.3	9	74.4	2.8

D4 Discontinued, use YB9L-A2

D5 Discontinued

PLATINUM O.E. CONVENTIONAL

Specifications

6 VOLT

DRY PART NO. (opt.)	PART NO. W/ACID PACK (std.)	BATTERY TYPE	CAPACITY AH (10H-R)	DIMENSIONS - INCHES (± 1/16 IN)			DIMENSIONS - MILLIMETERS (± 2 MM)			ASSEMBLY FIGURE (AS PER COVER POLARITY)	WEIGHT W/O ACID (LBS)	TERMINAL TYPE (REFER TO PAGE 3)	ACID VOLUME (OZ)	REGULAR CHARGE CURRENT (AMP)
				L	W	H	L	W	H					
M2620A	M3620A	6N2-2A	2	2 3/4	1 7/8	3 3/4	70	47	96		1.0	-	3.4	0.2
M2621A	-	6N2-2A-1	2	2 3/4	1 7/8	3 3/4	70	47	96		1.0	-	3.4	0.2
M2623A	-	6N2-2A-3	2	2 3/4	1 7/8	3 3/4	70	47	96		1.0	-	3.4	0.2
M2620B	M3620B	6N2-2A-4	2	2 3/4	1 7/8	3 3/4	70	47	96		1.0	-	3.4	0.2
M26228	-	6N2-2A-8	2	2 3/4	1 7/8	3 3/4	70	47	96		1.0	-	3.4	0.2
M262AC	-	6N2A-2C	2	2 3/4	1 7/8	4 3/16	70	47	106		1.0	-	3.4	0.2
M262C3	M362C3	6N2A-2C-3	2	2 3/4	1 7/8	4 3/16	70	47	106		1.0	-	3.4	0.2
M2640B	M3640B	6N4-2A	4	2 13/16	2 13/16	3 3/4	71	71	96		1.3	-	6.8	0.4
M2643A	-	6N4-2A-3	4	2 13/16	2 13/16	3 3/4	71	71	96		1.3	-	6.8	0.4
M2644A	M3644A	6N4-2A-4	4	2 13/16	2 13/16	3 3/4	71	71	96		1.3	-	6.8	0.4
M2645A	M3645A	6N4-2A-5	4	2 13/16	2 13/16	3 3/4	71	71	96		1.3	-	6.8	0.4
M2646A	M3646A	6N4-2A-6	4	2 13/16	2 13/16	3 3/4	71	71	96		1.3	-	6.8	0.4
M2648A	M3648A	6N4-2A-8	4	2 13/16	2 13/16	3 3/4	71	71	96		1.3	-	6.8	0.4
M26A4B	M36A4B	6N4A-4D	4	2 3/8	2 1/4	5 1/8	61	57	131		1.7	-	6.8	0.4
M26B4B	M36A4B	6N4B-2A	4	4	1 7/8	3 3/4	102	48	96		1.7	-	6.8	0.4
M26B43	-	6N4B-2A-3	4	4	1 7/8	3 3/4	102	48	96		1.7	-	6.8	0.4
M26B45	-	6N4B-2A-5	4	4	1 7/8	3 3/4	102	48	96		1.7	-	6.8	0.4
M26C4B	M36C4B	6N4C-1B	4	2 13/16	2 13/16	4 1/8	71	71	105		1.4	-	6.8	0.4
M2655B	M3655B	6N5.5-1D	5.5	3 9/16	2 3/4	3 15/16	90	70	100		1.8	-	10.1	0.6
M2661B	M3661B	6N6-1B	6	3 7/8	2 1/4	4 3/8	99	57	111		2.0	-	10.1	0.6
M2660B	M3660B	6N6-3B	6	3 7/8	2 1/4	4 3/8	99	57	111		2.0	6	10.1	0.6
M2663B	M3663B	6N6-3B-1	6	3 7/8	2 1/4	4 3/8	99	57	111		2.0	6	10.1	0.6
M2662B	M3662B	6N6-1D-2	6	3 7/8	2 1/4	4 3/8	99	57	111		2.0	-	10.1	0.6
M2670J	-	B39-6	7	4 15/16	1 7/8	4 15/16	126	48	126		2.8	6	10.1	0.7
M26112	-	6N11-2D	11	5 7/8	2 3/4	3 15/16	150	70	100		3.5	6	13.5	1.1
M26111	-	6N11A-1B	11	4 13/16	2 7/16	5 1/8	122	62	131		3.5	6	13.5	1.1
M2612J	-	B54-6	12	6 1/8	2 1/4	4 9/16	156	57	116		3.8	6	16.9	1.2
M2612D	-	6N12A-2D	12	6 1/8	2 1/4	4 9/16	156	57	116		3.8	6	15.2	1.2
M2614J	-	B38-6A	13	4 11/16	3 1/4	6 15/16	119	83	161		4.7	6	21.0	1.3
M268LB	-	6YB8L-B	8	4 3/4	2 3/4	3 3/4	120	70	95		3.0	6	10.5	0.8
M2611L	-	6YB11-2D	11	5 7/8	2 3/4	3 15/16	150	70	100		6	13.5	1.1	

BATTERY UPGRADECROSS REFERENCE

Yuasa	EXIDE	Deka	Delco	Interstate	GS-Ztong Yee	GS-JSB	Motocross	NAPA	Sears	Wal-Mart	Yacht
Premium Maintenance Free											
YTR4A-BS	-	-	-	CYTR4A-BS	GTR4A-5	-	M62R4A	-	-	-	-
YT4B-BS	-	-	-	CYT4B-BS	GT4B-5	-	M62T4B	-	-	-	-
YTX4L-BS	4L-BS	-	GT4L-BS	CYTX4L-BS	GT4L-BS	-	M62X4B	740-1865	44015	ES4LBS	CT4L-BS
YTX5L-BS	5L-BS	-	GTX5L-BS	CYTX5L-BS	GTX5L-BS	-	M32X5B	-	44022	-	-
YTX7A-BS	7A-BS	-	-	CYTX7A-BS	GTX-7A-BS	-	M32X7A	-	44023	-	CTX7A-BS
YT7B-BS	-	-	-	CYT7B-BS	GT7B-4	-	M62T7B	-	-	-	-
YTX7L-BS	7L-BS	-	-	CYTX7L-BS	-	GTX7L-BS	M327BS	-	44024	-	CTX7L-BS
YTZ7S	-	-	-	FAYTZ7S	GT6B-3	-	M727ZS	-	-	-	-
YTX9-BS	9-BS	ETX9	GTX9-BS	CYTX9-BS	GTX9-BS	-	M329BS	740-1825	44025	-	CTX9-BS
YT9B-BS	-	-	-	CYT9B-BS	GT9B-4	-	M629B4	-	-	-	-
YTZ10S	-	-	-	FAYTZ10S	-	-	M7210A	-	-	-	-
YTX12-BS	12-BS	ETX12	GTX12-BS	CYTX12-BS	GTX12-BS	-	M3RH2S	740-1866	44016	ES12BS	CTX12-BS
YT12B-BS	-	-	-	CYT12B-BS	GT12B-4	-	M6212B	-	-	-	-
YTZ12S	-	-	-	FAYTZ12S	-	-	M7212A	-	-	-	-
YTX14-BS	14-BS	ETX14	GTX14-BS	CYTX14-BS	GTX14-BS	-	M3RH4S	740-1886	44017	ES14BS	CTX14-BS
YTX14AH-BS	-	ETX15	-	CYTX14AH-BS	-	-	M62H4A	-	44004	-	-
YTX14AHL-BS	-	ETX15L	-	CYTX14AHL-BS	-	-	M62H4L	-	44005	-	-
YT14B-BS	-	-	-	CYT14B-BS	GT14B-4	-	M624B4	-	-	-	-
YTX14L-BS	-	-	-	CYTX14L-BS	-	-	-	-	-	-	-
YTZ14S	-	-	-	FAYTZ14S	-	-	M72Z14	-	-	-	CTX20L-BS
YTX15L-BS	-	-	-	CYTX15L-BS	-	-	M6215L	-	44162	-	-
YTX16-BS	-	-	-	CYTX16-BS	-	-	M32X6S	-	-	-	-
YTX20-BS	16-BS	ETX16	TBA	CYTX20-BS	GT16-BS	-	M32RBS	TBA	44028	-	-
YTX20CH-BS	-	-	-	CYTX20CH-BS	-	-	M6220C	-	-	-	-
YTX20L-BS	16L-BS	ETX16L	TBA	CYTX20L-BS	GT16L-BS	-	M320BS	TBA	44027	-	-
YTX20L-BS	20L-BS	ETX20L	TBA	CYTX20L-BS	GTX20L-BS	-	M320BS	TBA	44027	-	CTX20L-BS
YTX24HL-BS	18L-BS	ETX18L	TBA	CYTX24HL-BS	GTX18L-BS	-	M6250H	TBA	44006	-	-
YIX30L	-	-	-	FAYIX30L	-	YGIX30	M7230L	-	-	-	-

BATTERY UPGRADE CROSS REFERENCE (continued)

Yuasa	EXIDE	Deka	Delco	Interstate	GS-Ziong Yee	GS-JSB	Motocross	NAPA	Sears	Wal-Mart	Yacht
Premium											
YB2.5L-C	2.5L-C	-	-	YB2.5L-C	CB2.5L-C	GM2.5A-3C-3	M325LC	-	44035	-	CB2.5L-C
YB2.5L-C-1	2.5L-C-1	-	-	YB2.5L-C-1	CB2.5L-C-1	GM2.5A-3C-1	M32LC1	-	44036	-	CB2.5L-C-1
YB3L-A	3L-A	-	-	YB3L-A	CB3L-A	GM3-3A	M323LA	-	44037	-	CB3L-A
YB3L-B	3L-B	-	-	YB3L-B	CB3L-B	GM3-3B	M223LB	-	44038	-	CB3L-B
YB4L-A	4L-A	-	-	YB4L-A	CB4L-A	GM4A-3B	M224LA	-	44039	-	CB4L-A
YB4L-B	4L-B	-	MC0414	YB4L-B	CB4L-B	GM4-3B	M324LB	740-1861	44014	-	CB4L-B
YB5L-B	5L-B	-	-	YB5L-B	CB5L-B	GM5Z-3B	M325LB	740-1868	44353	-	CB5L-B
YB7-A	7-A	-	-	YB7-A	CB7-A	GM7Z-4A	M227AY	-	44040	-	CB7-A
YB7C-A	7C-A	-	-	YB7C-A	-	GM7CZ-3D	M227CY	M227CY	44041	-	CB7C-A
YB7L-B	7L-B	-	-	YB7L-B	CB7L-B	GM7-3B-1	M2273Y	-	44042	-	CB7L-B
YB9A-A	9AA	-	CB9A-A	YB9A-A	CB9A-A	GM9AZ-4A	M329AY	740-1872	44043	-	CB9A-A
YB9L-A2	9L-A2	-	-	YB9L-A2	CB9L-A2	-	M2292Y	-	44044	-	CB9L-A2
YB9-B	9-B	-	-	YB9-B	CB9-B	GM9Z-4B	M329BY	740-1858	44356	-	CB9-B
YB9L-B	9LB	-	-	YB9L-B	CB9L-B	GM9Z-3B	M329LY	740-1837	44045	-	CB9L-B
YB10A-A2	10A-A	-	-	YB10A-A2	CB10A-A	-	M321AY	-	44046	-	CB10A-A
YB10L-A2	10LA2	-	MC1114	YB10L-A2	CB10L-A2	GM10Z-3A	M3210Y	740-1857	44355	ES10LA2	CB10L-A2
YB10L-B	10L-B	-	-	YB10L-B	CB10L-B	GM10-3B	M321LB	740-1831	44047	-	CB10L-B
YB10L-B2	10L-B2	-	-	YB10L-B2	CB10L-B2	-	M221L2	740-1832	44048	-	-
YB12A-A	12AA	-	MC1216	YB12A-A	CB12A-A	GM12AZ-4A-1	M3212Y	740-1854	44358	ES12AA	CB12A-A
YB12AL-A	12AL-A	-	-	YB12AL-A	CB12AL-A	GM12AZ-3A-1	M3221Y	740-1873	44052	-	CB12AL-A
YB12A-B	12A-B	-	-	YB12A-B	-	-	M222AB	-	44053	-	CB12A-B
YB12B-B2	12B-B2	-	-	YB12B-B2	CB12B-B2	GM12B-4B	M221B2	-	44054	-	CB12B-B2
YB12C-A	12C-A	-	-	YB12C-A	-	GM12CZ-4A-2	M222CA	-	44055	-	CB12C-A
YB14-A2	14-A2	-	-	YB14-A2	CB14-A2	GM14Z-4A	M3214H	740-1864	44363	-	CB14-A2
YB14A-A1	14AA1	-	-	YB14A-A1	CB14A-A	GM14AZ-4A	M224A1	740-1826	44056	-	CB14A-A1
YB14A-A2	14AA2	-	MC1418	YB14A-A2	CB14A-A2	GM14AZ-4A-1	M3214A	740-1860	-	ES14AA2	CB14A-A2
YB14L-A1	14L-A1	-	-	YB14L-A1	CB14L-A1	GM14Z-3A-1	M22141	-	44057	-	CB14L-A1
YMF14L-2 *	14L-2	-	-	-	-	-	-	-	-	-	-
YB14L-A2	14L-A2	-	MC1406	YB14L-A2	CB14L-A2	GM14Z-3A	M3214Y	740-1851	44364	ES14L-A2	CB14L-A2
YB14L-B2	14L-B2	-	-	YB14L-B2	CB14L-B2	GM14Z-3B	M2214B	740-1828	44059	-	CB14L-B2
YB14-B2	14-B2	-	-	YB14-B2	CB14-B2	-	M224B2	-	44060	-	CB14-B2
SYB14L-A2	14LA2	-	-	SYB14L-A2	SCB14-LA2	-	M2214S	-	44061	-	SCB14-LA2
SYB14L-B2	14-LB2	-	-	SYB14L-B2	SCB14-LB2	-	M22B4S	-	44062	-	SCB14-LB2
YB16AL-A2	16ALA2	-	CB16AL-A2	YB16AL-A2	CB16AL-A2	GM16A-3A	M32162	740-1877	44063	-	CB16AL-A2
HYB16A-AB	16AA	-	-	HYB16A-AB	HCB16A-A	GM16-T	M32H6B	740-1867	44064	-	HCB16A-A
YB16-B	16B	-	MC1912	YB16-B	CB16-B	GM16Z-4BH	M3216Y	740-1852	44366	ES16B	CB16-B
YB16L-B	16LB	-	-	YB16L-B	CB16L-B	GM16Z-3B	M3216K	740-1827	44065	-	CB16L-B
YB16-B-CX	16-B-LM	-	-	YB16-B-LM	GT16-BS	-	M3216C	-	44029	-	CB16-B-LM
YB16HL-A-CX	16HL-A-LM	-	-	YB16HL-A-LM	GT16L-BS	-	M2H16C	-	-	-	CB16HL-A-LM
YB16B-A	16B-A	-	-	YB16B-A	-	GM16B-4A	M2216B	-	44066	-	CB16B-A
YB16B-A1	16B-A1	-	-	YB16B-A1	-	-	M22161	-	44067	-	CB16B-A1
YB16C-B	16C-B	-	-	YB16C-B	-	-	M326CB	-	44068	-	-
YB16CL-B	16CLB	-	M1924	YB16CL-B	CB16CL-B	GM16AZ-3B	M3S6CL	740-1862	44001	ES16CLB	CB16CL-B
SYB16L-B	16L-B	-	-	SYB16L-B	SCB16L-B	-	M22S6A	-	44069	-	SCB16L-B
YB18-A	18-A	-	-	YB18-A	CB18-A	GM18A-4A	M321Y	740-1874	44070	-	CB18-A
YB18L-A	18LA	-	-	YB18L-A	CB18L-A	GM18A-3A	M3218L	740-1871	44071	-	CB18L-A
Y50-N18A-A	50-N18A-A	-	-	Y50-N18A-A	-	-	M228AY	-	44072	-	C50-N18A-A
Y50-N18L-A	50N18LA2	-	MC2008	Y50-N18L-A	C50-N18L-A3	GM18Z-3A(S)	M3218Y	-	-	ES50N-N18L-A	SCB50-N18L-A
Y50-N18L-A3	50N18LA3 **	-	-	Y50-N18L-A3	C50-N18L-A3	-	M328A3	740-1855	44359	-	C50-N18L-A3
Y60-N24-A	60-N24-A	-	-	Y60-N24-A	C60-N24L-A	-	M2224A	-	44074	-	C60-N24-A
Y60-N24AL-B	60-N24AL-B	-	-	Y60-N24AL-B	-	-	M2224B	740-1880	44075	-	C60-N24AL-B

* Superseded by YTX14AHL-BS
 ** EXIDE's 50N18LA2 replaces 50N18LA3



MOTORCYCLE

**Recommend
High Performance
Batteries**

for

**• More Power
• Less Maintenance
• Longer Life**

cc	Model	Year	High Performance Maintenance Free	Maintenance Free VRLA	YuMicron	Conventional	cc	Model	Year	High Performance Maintenance Free	Maintenance Free VRLA	YuMicron	Conventional
BIG DOG							HARLEY-DAVIDSON (continued)						
All Models All Years YTX20HL-BS* YTX20L-BS - -							1000 XLX-61, XR1000 '83-'85 YTX20H-BS* YTX20-BS* YB16-B-CX* YB16-B						
BUELL							883 XL, XLH (Sportster) '04-'08 - YTX14L-BS - -						
1200 X1 Lightning 99-'02 YTX20HL *FA YTX20L FA - -							XL, XLH (Sportster) '97-'03 YTX20HL-BS* YTX20L-BS - -						
S1 Lightning 96-'99 - YTX14-BS ### - -							XLH (Sportster) '86-'96 YTX20H-BS* YTX20-BS* YB16-B-CX YB16-B						
S3, S3T Thunderbolt 97-'02 YTX20HL-BS* YTX20L-BS - -							500 MT500 (Military) All Years YTX14AHL-BS* - -						
M2 Cyclone 97-'02 YTX20HL-BS* YTX20L-BS - -							350 SS350 All Years - - - 6N11A-1B						
S2, S2T Thunderbolt 94-'96 YTX20H-BS* YTX20-BS* YB16-B-CX - -							250 SS250, SX250 '75-'78 - - - YB7L-B* 12N7-3B						
RR1200 88-'90 YTX20H-BS* YTX20-BS* YB16-B-CX - -							175 SS175, SX175 '74-'78 - - - YB7L-B* 12N7-3B						
RS1200 89-'93 YTX20H-BS* YTX20-BS* YB16-B-CX - -							125 SS125, SX125 '74-'78 - - - YB7L-B* 12N7-3B						
RSS1200 91-'93 YTX20H-BS* YTX20-BS* YB16-B-CX - -							TX125 '75-'78 - - - YB7L-B* 12N7-3B						
XB12R Firebolt, XB12S Lightning 04-'08 YTX14H-BS*FA YTX14 FA - -							90 Z90 '73-'76 - - - YB7L-B* 12N7-3B						
XB12X Ulysses 06-'09 YTX14H-BS*FA YTX14 FA - -							HONDA						
1125 1125R 08-'09 - YTX14L FA - -							1800 GL1800 Gold Wing '09 GYZ20L - - -						
1000 RR1000 87 YTX20H-BS* YTX20-BS* YB16-B-CX - -							GL1800 Gold Wing '01-'08 GYZ20L* YTX20L-BS - - -						
984 XB9R Firebolt, XB9S Lightning 02-'09 YTX14H FA YTX14 FA - -							VTX1800C, F, N, R Retro, S '02-'07 YTX20HL-BS* YTX20L-BS - - -						
500 Blast 00-'09 YTX14H-BS* YTX14-BS - -							NRX1800 Valkyrie Rune '04-'05 YTX20HL-BS* YTX20L-BS - - -						
CAN-AM							1500 GL1500 Gold Wing '88-'00 YTX24HL-BS* - Y50-N18L-A3 - -						
990 Spyder 08-'09 YTX24HL FA - - -							GL1500 Valkyrie '97-'03 YTX14H-BS* YTX14-BS - - -						
CANNONDALE							1300 ST1300, A, P '03-'09 YTX14S - - -						
440 C440, E440, S440, X440, X440S 02-'03 YTZ7S - - -							VTX1300C, R, S, Retro '03-'09 YTX14H-BS* YTX14-BS - - -						
EX400, MX400, XC400 00-'01 YTZ7S* YTX5L-BS - -							GL1200 Gold Wing '84-'87 YTX24HL-BS* - Y50-N18L-A-CX* Y50-N18L-A						
EXCELSIOR-HENDERSON							1100 CB1100F Super Sport '83 '83 YTX14AHL-BS* - YB14L-A2* - -						
1386 Super X 99-'00 YTX20HL-BS* YTX20L-BS - -							CBR1100XX '01-'04 YTZ12S - - -						
HARLEY-DAVIDSON							CBR1100XX '97-'00 YTX14H-BS* YTX12-BS - - -						
1580 FXD Series (Dyna) '07-'09 YTX20HL-BS* YTX20L-BS - -							GL1100 Gold Wing '80-'83 YTX24HL-BS* - Y50-N18L-A-CX* Y50-N18L-A						
FXST, FLST Series (Softail) '07-'09 YTX20HL-BS* YTX20L-BS - -							ST1100, ABS-TCS, 1100A '91-'02 - YTX14-BS - -						
FL, FLH Series (Touring) '07-'09 - YIX30L - - -							VF1100C V65 Magna '83-'86 YTX20H-BS* YTX20-BS* YB18-A - -						
1450 FXD Series (Dyna) 99-'06 YTX20HL-BS* YTX20L-BS - -							VF1100S V65 Sabre '84-'85 YTX20HL-BS* YTX20L-BS* YB18L-A - -						
FXST, FLST Series (Softail) 00-'06 YTX20HL-BS* YTX20L-BS - -							VT1100C2 Shadow Sabre '00-'07 YTX14H-BS* YTX14-BS - -						
FL, FLH Series (Touring) 00-'06 - YIX30L - - -							VT1100C, C3, T Shadow (Spirit, Aero, A. C. E. Tourer) '01-'07 YTX14H-BS* YTX14-BS - -						
FL, FLH Series (Touring) 99 - YIX30L* YB30L-B - -							VT1100C, C3 (Spirit, Aero, A. C. E. Tourer) '98-'00 YTX14S* - - -						
1340 FXD/FXST Series (Dyna) 97-'99 YTX20HL-BS* YTX20L-BS - -							VT1100C Shadow Spirit '85-'97 YTX14S* - - -						
FXD/FXST Series (Dyna) 91-'96 YTX20HL-BS* YTX20L-BS YB16HL-A-CX - -							VT1100C2 Shadow A. C. E. '95-'99 YTX14S* - - -						
FX/FXR Series 79-'94 YTX20H-BS* YTX20-BS* YB16-B-CX* YB16-B - -							1000 CB1000 '94-'95 - YTX12-BS - - -						
FXR Series 99-'00 YTX20H-BS* YTX20-BS* YB16-B-CX* YB16-B - -							CB1000C Custom '83 YTX14AHL-BS - - -						
FLST Series (Softail) 97-'99 YTX20HL-BS* YTX20L-BS - -							CBR1000F Hurricane '87-'96 YTX14AHL-BS - - -						
FLST Series (Softail) 91-'96 YTX20HL-BS* YTX20L-BS YB16HL-A-CX - -							CBR1000RR '08-'09 YTZ7S - - -						
FXST/FLST Series (Softail) 84-'90 YTX20H-BS* YTX20-BS* YB16-B-CX - -							CBR1000RR '04-'07 YTZ10S - - -						
FL, FLH Series (Touring) 80-'96 YTX24HL-BS* - Y50-N18L-A-CX - -							CBX1000 Super Sport '79-'82 YTX20HL-BS* YTX20L-BS* YB18L-A - -						
FL, FLH Series (Touring) 97-'98 - YIX30L - - -							CBX1000 Super Sport (Opt) '82 YTX24HL-BS* - Y50-N18L-A-CX* Y50-N18L-A						
FL, FLH Series (Touring) 78-'84 - - -							GL1000 Gold Wing '75-'79 YTX24HL-BS* - - -						
1250 VRSC V-Rod 08-'09 - YTX20HL *FA YTX20L FA - -							RVT1000R RC51 '00-'06 YTZ12S - - -						
1200 XL, XLH (Sportster) 04-'09 - YTX14L-BS - -							VTR1000F Super Hawk '01-'05 YTZ12S - - -						
XL, XLH (Sportster) 97-'03 YTX20HL-BS* YTX20L-BS - -							VTR1000F Super Hawk '97-'00 - YTX12-BS - - -						
XL, XLH (Sportster) 87-'96 YTX20H-BS* YTX20-BS* YB16-B-CX - -							VF1000R, F '84-'86 - - -						
FX Series (Electric Start) '71-'78 YTX20H-BS* YTX20-BS* YB16-B-CX YB16-B - -							954 CBR954RR '02-'03 YTZ10S - - -						
FX Series (Kick Start) 71-'72 - - -							929 CBR929RR, RE '00-'01 YTZ10S - - -						
FL/FLH Series (Touring) 65-'77 - - -							919 CB900F (919) '02-'06 YTZ10S - - -						
1130 VRSC V-Rod 02-'07 YTX14H *FA YTX14 *FA - -							900 CB900C, F '80-'82 YTX14AHL-BS - - -						
1100 XL Series (Sportster) 87-'93 YTX20H-BS* YTX20-BS* YB16-B-CX* YB16-B - -							CBR900R, RR '93-'99 - YTX9-BS - - -						
1000 XL Series (Sportster) 79-'85 YTX20H-BS* YTX20-BS* YB16-B-CX* YB16-B - -							800 PC800 Pacific Coast '89-'98 - YTX12-BS - - -						
XLCH Series (Sportster Kick Start) 70-'78 - - -							VFR800, A Interceptor, ABS '02-'09 YTZ12S - - -						
XLCR Cafe Racer 77-'78 YTX20H-BS* YTX20-BS* YB16-B-CX* YB16-B - -							VFR800FI Interceptor '98-'01 - YTX12-BS - - -						
XLH (Sportster Electric Start) 67-'78 - - -							VT800C Shadow '88 YTX14AH-BS* - - -						
							750 CB750 Nighthawk '91-'03 YTX14AH-BS* - - -						
							CB750A Hondamatic '76-'78 YTX24HL-BS* - - -						
							CB750C Custom '80-'82 YTX14AHL-BS* - - -						
							CB750F Super Sport '75-'82 YTX14AHL-BS* - - -						
							CB750K Four '69-'82 YTX14AHL-BS* - - -						
							CB750K Limited Edition '79 YTX14AHL-BS* - - -						
							CB750SC Nighthawk '82-'83 YTX14AHL-BS* - - -						

Must use adaptor kit available from Buell.

* See Battery Upgrade Cross Reference Chart on page 9.

FA Must use Factory Activated battery.

C Requires use of Cover/Spacer Kit, see part no. 478651 on the bottom of page 5.

**Recommend
High Performance
Batteries**

for
 • **More Power**
 • **Less Maintenance**
 • **Longer Life**

MOTORCYCLE



cc	Model	Year	High Performance Maintenance Free	Maintenance Free VRLA	YuMicron	Conventional	cc	Model	Year	High Performance Maintenance Free	Maintenance Free VRLA	YuMicron	Conventional
HONDA (continued)							HONDA (continued)						
750	RVF750R (RC45)	'94	-	YTX9-BS	-	-	400	CM400 (All)	'79-'81	-	-	YB12A-A	-
	VF750C V45 Magna	'88	-	-	YB12A-A	-	360	CB360, G, T	'74-'76	-	-	YB12A-A*	12N12A-4A-1
	VF750C V45 Magna	'82-'83	YTX14AH-BS*	-	YB14-A2	-		CJ360T	'76-'77	-	-	YB9-B*	12N9-4B-1
	VF750C, C2, D Magna	'94-'03	-	YTX12-BS	-	-		CL360 Scrambler	'74-'75	-	-	YB12A-A*	12N12A-4A-1
	VF750F V45 Interceptor	'83-'84	YTX14AH-BS*	-	YB14-A2	-	350	CB350 Super Sport Four	'68-'74	-	-	YB12A-A*	12N12A-4A-1
	VF750S V45 Sabre	'82-'83	-	-	YB14L-A2 w/s †	-		CL350 Scrambler	'68-'73	-	-	YB12A-A*	12N12A-4A-1
	VFR750F Interceptor	'86	-	-	YB12A-B	-		SL350 Motosport	'70-'73	-	-	-	12N5-4B
	VFR750F	'90-'97	-	YTX12-BS	-	-		SL350 Motosport	'69-'70	-	-	YB12A-A*	12N12A-4A-1
	VFR750R (RC30)	'90	-	YTX9-BS	-	-		XL350	'74-'78	-	-	-	6N6-3B
	VT750C, CA, C2	'04-'08	YTZ12S	-	-	-		XL350R	'84-'85	-	-	YB3L-A	-
	VT750C Shadow	'88-'00	YTX14H-BS*	YTX14-BS	-	-	305	CA77 Dream Touring (late)	'63-'69	-	-	-	12N9-3A
	VT750CD, CD2 Shadow Deluxe	'98-'02	YTX14H-BS*	YTX14-BS	-	-		CB77 Super Hawk	'61-'68	-	-	-	12N9-3A
	VT750CDA, B, C, D Shadow	-	-	-	-	-		CL77 Scrambler	'65-'68	-	-	-	12N5-4B
	A.C.E. Deluxe	'02-'03	YTX14H-BS*	YTX14-BS	-	-	250	CA72 Dream Touring (late)	'63-'66	-	-	-	12N9-3A
	VT750C Shadow	'83	-	-	HYB16A-AB	-		CB250 Nighthawk	'91-'09	-	YTX7L-BS	-	-
	VT750C, CA, C2 Shadow Spirit, Aero	'07-'09	YTZ12S	-	-	-		CB72 Hawk	'61-'66	-	-	-	12N9-3A
	VT750DC, A, B Shadow Spirit	'01-'07	YTZ14S	-	-	-		CL72 Scrambler	'62-'65	-	-	-	12N5-4B
700	CB700SC Nighthawk S	'84-'86	-	-	YB14L-A1	-		CM250C Custom	'82-'83	-	-	YB9-B	-
	VF700C Magna	'87	-	-	YB12A-A	-		CMX250C Rebel	'96-'09	-	YTX7L-BS	-	-
	VF700C Magna	'84-'86	YTX14AH-BS*	-	YB14-A2	-		CMX250C Rebel, LTD	'85-'87	-	-	YB9L-B	-
	VF700F Interceptor	'84-'85	YTX14AH-BS*	-	YB14-A2	-		CRF250X	'04-'09	YTZ7S*	YTX5L-BS	-	-
	VF700S Sabre	'84-'85	YTX14AHL-BS*	-	YB14L-A2	-		MT250 Elsinore	'74-'76	-	-	-	6N6-3B
	VFR700 Interceptor	'86-'87	-	-	YB12A-B	-		NX250	'88-'90	-	YTX7L-BS	-	-
	VT700C Shadow	'86-'87	YTX14AH-BS*	-	YB14-B2	-		VTR250 Interceptor VTR	'88-'90	-	-	YB9-B	-
	VT700C Shadow	'84-'85	-	-	HYB16A-AB	-		XL250	'72-'76	-	-	-	6N6-3B
680	DN-01	'09	YTZ14S	-	-	-		XL250R	'82-'87	-	-	YB3L-A	-
650	CB650, Custom	'79-'82	-	-	YB12A-A	-		XL250S	'78-'81	-	-	-	6N4-2A-4
	CB650SC Nighthawk	'83-'85	-	-	YB12AL-A	-		XR250L	'91-'96	-	YTX4L-BS	-	-
	CB650SC Nighthawk	'82	-	-	YB12A-A	-	230	CRF230L	'08-'09	YTZ7S	-	-	-
	CX650C Custom	'83	YTX14AH-BS*	-	YB14-A2	-		CRF230F, L ('07)	'03-'09	YTZ7S*	YTX5L-BS	-	-
	CX650T Turbo	'83	YTX14AHL-BS*	-	YB14L-A2	-	200	CB200, T	'74-'76	-	-	YB9-B*	12N9-4B-1
	GL650I Silver Wing Interstate	'83	YTX14AHL-BS*	-	YB14L-A2	-		CL200 Scrambler	'74	-	-	YB9-B*	12N9-4B-1
	NT650 Hawk GT	'88-'91	-	YTX9-BS	-	-		CM200T Twinstar	'81-'82	-	-	YB9-B*	12N9-4B-1
	NT650V	-	-	YTR9-BS	-	-		CM200T Twinstar	'80	-	-	-	6N12A-2C
	NX650	'88-'89	-	YTX9-BS	-	-		TLR200 Reflex	'86-'87	-	YTX4L-BS	-	-
	SLR650	-	-	YTR9-BS	-	-		TR200 Fat Cat	'87	-	YTX7A-BS	-	-
	Vigor 650	-	-	YTR9-BS	-	-		TR200 Fat Cat	'86	-	YTX9-BS	-	-
	XR650L	'93-'09	-	YTX9-BS	-	-		XL200R	'83-'84	-	-	YB3L-A	-
600	CB600F (599)	'04-'06	-	YTX7L-BS	-	-	185	CM185T Twinstar	'78-'79	-	-	-	6N12A-2C
	CBR600	'87-'00	-	YTX9-BS	-	-		CL185S	'79-'83	-	-	-	6N4-2A-4
	CBR600F4i, 600RR	'01-'09	YTZ10S	-	-	-	175	CA175 Touring (CD175)	'68-'69	-	-	-	B54-6
	VT600C, CD Shadow Deluxe	'04-'07	YTZ10S	-	-	-		CA175 Touring (CD175K3)	'69-'70	-	-	-	6N12A-2D
	VT600C, CD Shadow Deluxe, VLX	'88-'03	-	YTX9-BS	-	-		CB175 Super Sport	'69-'73	-	-	YB9-B*	12N9-4B-1
	XL600R	'83-'87	-	-	YB3L-A	-		CL175 Scrambler	'68-'73	-	-	YB9-B*	12N9-4B-1
	XL600V Transalp	'89-'90	-	-	YB12A-B	-		SL175 Motosport	'70-'72	-	-	-	12N5-4B
550	CB550 Four, K, SS	'74-'78	-	-	YB12A-A*	12N12A-4A-1		XL175	'73-'78	-	-	-	6N6-3B
	CB550SC Nighthawk	'83	-	-	YB12AL-A	-	160	CB160 Sport	'65-'69	-	-	YB9-B*	12N9-4B-1
500	CB500 Four, Twin	'71-'76	-	-	YB12A-A	12N12A-4A-1		CL160 Scrambler	'66-'68	-	-	YB9-B*	12N9-4B-1
	CX500, C, D, T	'78-'82	YTX14AHL-BS*	-	YB14L-A2	-	150	CRF150F	'06-'07	YTZ7S*	YTX5L-BS	-	-
	FT500 Ascot	'82-'83	YTX14AHL-BS*	-	YB14L-A2	-	125	CB125S	'81-'82	-	-	-	6N6-3B-1
	GB500	'89-'90	-	-	YB12A-B	-		CB125S	'73-'80	-	-	-	6N6-3B
	GL500, I Silver Wing	'81-'82	YTX14AHL-BS*	-	YB14L-A2	-		CL125A Scrambler (Twin)	'67-'69	-	-	-	B54-6
	VF500C V30 Magna	'84-'85	-	-	YB12A-A	-		CL125S Scrambler	'73-'75	-	-	-	6N4C-1B
	VF500F Interceptor	'84-'86	-	-	YB12A-A	-		CT125 Trail	'77	-	-	-	6N4C-1B
	VT500C Shadow	'83-'86	-	-	YB12A-A	-		MT125 Elsinore	'74-'76	-	-	-	6N6-3B
	VT500FT Ascot	'83-'84	-	-	YB12A-A	-		NX125	'88-'90	-	YTX7L-BS	-	-
	XL500R	'82	-	-	YB3L-A	-		SL125 Motosport	'71-'73	-	-	-	6N6-3B
	XL500S	'79-'81	-	-	-	6N4-2A-4		SS125A Super Sport	'67-'69	-	-	-	B54-6
450	CB450, SS	'67-'74	-	-	YB12A-A*	12N12A-4A-1		XL125	'74-'78	-	-	-	6N4C-1B
	CB450SC Nighthawk, T	'82-'86	-	-	YB12A-A	-		XL125S	'79-'84	-	-	-	6N4-2A-4
	CL450 Scrambler	'67-'74	-	-	YB12A-A*	12N12A-4A-1		XL125S	'85	-	-	YB2.5L-C	-
	CMX450A Hondamatic, E	'82-'83	-	-	YB12A-A	-	110	CT110 Trail	'86	-	-	-	6N4-2A-4
	CMX450C Rebel	'86-'87	-	-	YB12A-A	-		CT110 Trail	'80-'84	-	-	-	6N4-2A-8
	CRF450X	'05-'09	YTZ7S	-	-	-	100	CB100 Super Sport	'70-'72	-	-	-	6N6-3B
400	CB400A	'78	-	-	YB12A-A	-		CL100, S Scrambler	'70-'73	-	-	-	6N6-3B
	CB400F CB-1	'89-'90	-	YTX9-BS	-	-		SL100 Motosport	'70-'73	-	-	-	6N6-3B
	CB400F Super Sport	'75-'77	-	-	YB12A-A*	12N12A-4A-1		XL100	'77-'78	-	-	-	6N4C-1B
	CB400T Hawk, Hawk II	'78-'81	-	-	YB12A-A	-		XL100	'74-'76	-	-	-	6N6-3B
	CB400TI Hawk I	'78-'79	-	-	YB9-B*	12N9-4B-1				-	-	-	

† When ordering this battery, specify sensor.

* See Battery Upgrade Cross Reference Chart on page 9.



MOTORCYCLE

**Recommend
High Performance
Batteries**

for

**• More Power
• Less Maintenance
• Longer Life**

cc	Model	Year	High Performance Maintenance Free	Maintenance Free VRLA	YuMicron	Conventional	cc	Model	Year	High Performance Maintenance Free	Maintenance Free VRLA	YuMicron	Conventional
HONDA (continued)							KAWASAKI (continued)						
100	XL100S	'83-'85	-	-	-	6N4-2A-4	1100	KZ1100-B GP	'82	-	-	-	-
	XL100S	'81-'82	-	-	-	6N4C-1B		KZ1100-B GP	'81	YTX20HL-BS*	YTX20L-BS*	SYB16L-B	-
	XL100S	'79-'80	-	-	-	6N4-2A-4		ZN1100-B LTD	'84-'85	YTX14AHL-BS*	-	YB16L-B	-
90	CA200 Honda 90 (C200 Touring 90)	'63-'66	-	-	-	6N6-1D		ZR1100	'92-'95	YTX20CH-BS*	YTX16-BS	YB14L-A2	-
	CL90, L 5HP Scrambler	'67-'70	-	-	-	6N5.5-1D		ZRX1100	'99-'00	YTX14H-BS*	YTX14-BS	-	-
	CM91 Honda 90 (C90M)	'66-'69	-	-	-	6N6-1B		ZX1100-A GPz	'83-'84	-	-	SYB16L-B	-
	CT200 Trail 90	'64-'66	-	-	-	6N5.5-1D		ZX1100-C Ninja ZX-11	'90-'93	YTX14AHL-BS*	-	YB14L-A2	-
	CT90 Trail	'66-'79	-	-	-	6N5.5-1D		ZX1100-D Ninja ZX-11 (CN)	'93-'94	YTX14H-BS*	YTX14-BS	-	-
	EZ90 Cub	'91-'96	-	YTX5L-BS	-	6N5.5-1D		ZX1100-E Ninja ZX-11	'95-'01	YTX14H-BS*	YTX14-BS	-	-
	S90 Super (CS90)	'64-'69	-	-	-	6N5.5-1D		ZX1100-E (GPz1100), ABS	'95-'97	YTX14H-BS*	YTX14-BS	-	-
	SL90 Motosport	'69	-	-	-	6N6-1B		KZ1000-P Police	'02-'03/'05	YTX20HL-BS*	YTX20L-BS*	-	-
	ST90 Trail Sport	'73-'75	-	-	-	6N6-1B		KZ1000-P Police	'82-'01	YTX20HL-BS*	YTX20L-BS*	YB18L-A	-
80	XL80S	'83-'85	-	-	-	6N5.5-1D		KZ1000-C Police	'80-'81	YTX20HL-BS*	YTX20L-BS*	YB16L-B	-
	XL80S	'80-'82	-	-	-	6N4-2A-8		KZ1000-C Police, Z1-R	'78-'79	YTX14AHL-BS*	-	YB14L-A2	-
75	XL75	'77-'79	-	-	-	6N5.5-1D		KZ1000, LTD	'77-'80	YTX14AHL-BS*	-	YB14L-A2	-
70	C70 Passport	'82-'83	-	-	YB5L-B	6N4-2A-8		KZ1000-E ST, Shaft	'79-'80	YTX20HL-BS*	YTX20L-BS*	YB16L-B	-
	C70 Passport	'80-'81	-	-	6YB11-2D*	6N4C-1B		KZ1000-G Classic	'80	YTX14AHL-BS*	-	YB14L-A2	-
	C70M Honda	'70-'73	-	-	6N11-2D*	6N4C-1B		KZ1000, LTD, CSR	'81-'83	YTX20HL-BS*	YTX20L-BS*	YB18L-A	-
	CL70 Scrambler	'69-'73	-	-	-	6N5.5-1D-1		KZ1000-R Replica	'82-'83	YTX20HL-BS*	YTX20L-BS*	YB18L-A	-
	CT70	'91-'94	-	YTX4L-BS	-	-		Z1000	'03-'09	YTX9-BS	YTX9-BS	-	-
	CT70 Trail	'80-'82	-	-	-	6N4-2A-6		ZG1000-A Concours	'86-'06	YTX20HL-BS*	YTX20L-BS*	YB18L-A	-
	CT70 Trail	'74-'79	-	-	-	6N4C-1B		ZL1000-A	'87	YTX14AHL-BS*	-	YB14L-A2	-
	CT70 Trail, 70H	'69-'71	-	-	-	6N2A-2C		ZX10R	'86-'90	YTX14AHL-BS*	-	YB14L-A2	-
	CT70, 70H	'72-'73	-	-	-	6N2A-2C-3		ZX1000-A Ninja	'86-'90	YTX14AHL-BS*	-	YB14L-A2	-
	SL70 Motosport	'73	-	-	-	6N2A-2C-3		ZX1000-C Ninja (ZX-10R)	'04-'09	-	YT12B-BS	-	-
	SL70 Motosport	'71-'72	-	-	-	6N2A-2C		KZ900, LTD	'76-'77	-	-	YB10L-A2	-
	XL70	'74-'76	-	-	-	6N2A-2C-3		Vulcan 900 Classic	'06-'09	-	YTX12-BS	-	-
65	S65 Sport (CS65)	'65-'69	-	-	-	6N2A-2C		Z1 Series	'73-'75	YTX14AHL-BS*	-	YB14L-A2*	12N14-3A
55	C, CA105T Trail	'62-'65	-	-	-	6N2A-2C-3		ZL900-A Eliminator	'85-'86	YTX14AHL-BS*	-	YB14L-A2	-
50	C110, CA110	'59-'69	-	-	-	6N4C-1B		ZX900-A Ninja	'84-'86	YTX14AHL-BS*	-	YB14L-A2	-
	MB5	'82	-	-	YB2.5L-C	6N2A-2C		ZX900-B Ninja (ZX-9R)	'94-'97	-	YTX12-BS	-	-
	NA50 Express II	'80-'81	-	-	-	6N2-2A		ZX900-C Ninja (ZX-9R)	'98-'99	-	YTX9-BS	-	-
	NA50 Express II	'79	-	-	-	6N2-2A		ZX900-E, F Ninja (ZX-9R)	'00-'03	-	YTX9-BS	-	-
	NC50 Express	'80-'83	-	-	-	6N2-2A		VN800-A, B, E Vulcan, Classic, Drifter	'04-'06	-	YTX12-BS	-	-
	NC50 Express	'78-'79	-	-	-	6N2-2A		VN800-A, B, C, E Vulcan, Classic, Drifter	'95-'03	-	YTX14-BS	-	-
	NC50 Express	'77	-	-	-	6N2-2A		H2 Series	'72-'75	-	-	-	12N5.5-4A
	NS50F	'90	-	-	YB3L-A	6N4-2A-6		KZ750, LTD, CSR	'76-'79	-	-	SYB14L-A2	-
	NU50 Urban Express	'82-'83	-	-	YB2.5L-C-1	6N2A-2C-3		KZ750-E, H, L LTD	'80-'83	-	-	YB12A-A	-
	NU50M Urban Express Deluxe	'82-'83	-	-	YB4L-B	6N2A-2C-3		KZ750-F LTD, Spectre	'83	YTX14AHL-BS*	-	YB14L-A2	-
	NX50M Express SR	'81-'82	-	-	YB4L-B	-		KZ750-L Ninja	'93	-	YTX9-BS	-	-
	Z50A (K1)	'69-'70	-	-	-	-		KZ750-R GP	'82	-	-	YB12A-A w/s †	-
	ZB50	'88	-	YTX4L-BS	-	6N2A-2C-1		VN750-A Vulcan	'86-'06	YTX14AHL-BS*	-	YB14L-A2	-
								ZN750-A LTD	'84-'85	YTX14AHL-BS*	-	YB14L-A2	-
								ZR-7, S	'00-'03	-	YTX12-BS	-	-
								ZR750 (Z750S)	'05-'06	-	YTX9-BS	-	-
								ZR750-C Zephyr	'91-'94	-	YTX12-BS	-	-
								ZX750-E Turbo, GPz	'83-'85	-	-	SYB14L-A2	-
								ZX750-F Ninja	'87-'90	YTX14AHL-BS*	-	YB14L-A2	-
								ZX750-H Ninja ZX-7	'90	-	-	YB12AL-A2	-
								ZX750-H Ninja ZX-7	'89	YTX14AHL-BS*	-	YB14L-A2	-
								ZX750-J Ninja ZX-7	'91-'95	-	YTX12-BS	-	-
								ZX750 Ninja ZX, 7RR	'91-'97	-	YTX9-BS	-	-
								ZX750-P Ninja ZX-7R	'96-'03	-	YTX12-BS	-	-
								KZ700-A	'84	-	-	YB12A-A	-
								VN700-A Vulcan	'85	YTX14AHL-BS*	-	YB14L-A2	-
								ZN700-A LTD	'84-'85	YTX14AHL-BS*	-	YB14L-A2	-
								ER6n	'09	-	YTX12-BS	-	-
								KL650-A, E, KLR	'87-'08	YTX14AHL-BS*	-	YB14L-A2	-
								KL650-B Tengai	'90-'91	YTX14AHL-BS*	-	YB14L-A2	-
								KLE650 Versys	'08-'09	-	YTX12-BS	-	-
								KLX650C, R	'93-'96	-	YTX9-BS	-	-
								KZ650 SR, LTD, Custom	'77-'80	-	-	YB10L-A2*	12N10-3A-2
								KZ650-H CSR	'81-'83	-	-	YB12A-A*	-
								Ninja 650R	'06-'09	-	YTX12-BS	-	-
								W Series	'66-'70	-	-	YB7L-B*	12N7-3B
								W650	'00-'02	YTX14H-BS*	YTX14-BS	-	-
								ZX636-B, C Ninja ZX-6R	'03-'06	-	YTX9-BS	-	-
								KL600-A KLR	'84	-	-	YB4L-A	-
								KL600-B KLR	'85-'86	YTX14AHL-BS*	-	YB14L-A2	-
								ZL600 (All)	'86-'97	-	-	YB12A-A	-
								ZX600-A, B, C, D Ninja	'85-'96	-	-	YB12A-A	-
								ZX600-FA Ninja ZX-6R	'08-'09	-	YTX9-BS	-	-
								ZX600-E, F Ninja ZX-6, 6R	'93-'02	-	YTX12-BS	-	-
								ZX600-G, J Ninja ZX-6R	'98-'08	-	YTX9-BS	-	-
								ZX600-K, M, N Ninja ZX-6RR	'03-'06	-	YTX9-BS	-	-
								ZZR600	'05-'08	-	YTX9-BS	-	-
								ZZR600	'02-'04	-	YTX12-BS	-	-
INDIAN													
1638	1638 Chief	'02-'03	YTX24HL-BS	-	-	-							
1442	1442 Scout, Spirit	'02-'03	YTX20H-BS*	YTX20-BS	-	-							
	All Models	'99-'01	YTX20H-BS*	YTX20-BS	-	-							
KAWASAKI													
2000	VN2000-A Vulcan	'04-'09	YTX20CH-BS*	YTX16-BS	-	-							
1600	VN1600-A Vulcan Classic, D, Nomad	'03-'09	YTX20CH-BS*	YTX16-BS	-	-							
	VN1600-B Vulcan Mean Streak	'04-'09	YTX20CH-BS*	YTX16-BS	-	-							
1500	VN1500 Vulcan 88, SE	'87-'98	YTX24HL-BS*	-	Y50-N18L-A-CX*	Y50-N18L-A							
	VN1500-C Vulcan L	'96-'97	YTX24HL-BS*	-	Y50-N18L-A-CX*	Y50-N18L-A							
	VN1500-G, J, L, R												
	Vulcan Nomad, Drifter	'99-'05	YTX20CH-BS*	YTX16-BS	-	-							
	VN1500-D, E, N Vulcan Classic	'96-'09	YTX20CH-BS*	YTX16-BS	-	-							
	VN1500-P Vulcan Mean Streak	'02-'03	YTX20CH-BS*	YTX16-BS	-	-							
1400	ZX14 Ninja	'06-'09	YTX14H-BS*	YTX14-BS	-	-							
	ZG1400 Concours	'08-'09	YTX14H-BS*	YTX14-BS	-	-							
1300	KZ1300 Touring	'79-'82	YTX24HL-BS*	-	Y50-N18L-A-CX*	Y50-N18L-A							
	ZN1300-A Voyager	'83-'88	-	-	-	-							
1200	ZG1200 Voyager XII	'86-'03	YTX24HL-BS*	-	SY50-N18L-AT	-							
	ZRX1200R	'01-'05	YTX14H-BS*	YTX14-BS	-	-							
	ZX-12R	'00-'05	YTX14H-BS*	YTX14-BS	-	-							
	ZZR1200	'02-'05	YTX14H-BS*	YTX14-BS	-	-							
1100	KZ1100-A, LTD	'81-'83	YTX20HL-BS*	YTX20L-BS*	YB18L-A	-							

* See Battery Upgrade Cross Reference Chart on page 9.

† When ordering this battery, specify sensor.

** When ordering this battery, specify terminal adaptor.

**Recommend
High Performance
Batteries**

for

- More Power
- Less Maintenance
- Longer Life

MOTORCYCLE



cc	Model	Year	High Performance Maintenance Free	Maintenance Free VRLA	YuMicron	Conventional	cc	Model	Year	High Performance Maintenance Free	Maintenance Free VRLA	YuMicron	Conventional
KAWASAKI (continued)							POLARIS VICTORY (continued)						
550	KZ550-LTD, GP	'80-'83	-	-	YB12A-A	-	1507	Vegas, Kingpin, Hammer	'03-'05	YTX20HL-BS*	YTX20L-BS	-	-
	KZ550-F LTD	'84	-	-	YB12A-A**	-		V92TC Touring Cruiser	'02-'06	YTX20HL-BS*	YTX20L-BS	-	-
	KZ550-F Spectre	'83	-	-	YB12A-A**	-		V92SC Sport Cruiser	'00-'01	YTX20HL-BS*	YTX20L-BS	-	-
	KZ550-H GP	'82-'83	-	-	YB12A-A†	-		V92C, DC Classic, Deluxe Cruiser	'98-'04	YTX20HL-BS*	YTX20L-BS	-	-
	ZR550-B Zephyr	'90-'92	-	-	YB12A-A	-	SUZUKI						
	ZX550-A GPz	'84-'86	-	-	YB12A-A†	-	1800	VZR1800 (M109R)	'06-'09	YTX20CH-BS	-	-	-
500	EN500-A Vulcan	'90-'96	-	-	YB12A-A	-		VLR1800 (C109R)	'06-'09	YTX20CH-BS	-	-	-
	EN500-C Vulcan LTD	'96-'09	-	-	YB12AL-A2	-	1600	Marauder, Boulevard M95	'04-'05	YTX20CH-BS*	YTX16-BS	-	-
	EX500-A	'87-'93	YTX14AHL-BS*	-	YB14L-A2	-	1500	VL1500 Intruder, C90, T	'98-'09	-	YTX16-BS-1	-	-
	EX500-D Ninja 500R	'94-'09	YTX14AHL-BS*	-	YB14L-A2	-	1400	GV1400GC, D, T Cavalcade	'86-'88	YTX24HL-BS*	-	SY50-N18L-AT	-
	H1 Series	'73-'75	-	-	YB9L-B*	12N9-3B		VS1400GL Intruder, GLP, S83	'87-'09	-	YTX16-BS-1	-	-
	H1 Series	'69-'72	-	-	YB9-B*	12N9-4B-1	1300	GSX1300BK B-King	'08-'09	-	YTX12-BS	-	-
	KH500-A	'76	-	-	YB9L-B*	12N9-3B		GSX1300R Hayabusa	'99-'07	-	YTX12A-BS	-	-
450	EN450-A 454 LTD	'85-'90	-	-	YB12A-A	-	1400	GSX1300R, Z Hayabusa	'08-'09	-	YTX12-BS	-	-
	KLX450R	'08-'09	YTX7S	-	-	-	1250	GSF1250S, A Bandit	'07-'09	-	YTX12A-BS	-	-
440	KZ440 (All)	'80-'83	-	-	YB12A-A	-	1200	GSF1200, S Bandit	'97-'05	-	YTX12-BS	-	-
400	KH400-A	'76-'78	-	-	-	12N5.5-4A		GV1200GL Madura	'85-'86	YTX14AHL-BS*	-	YB14L-B2	-
	KLX400R, KLX400SR	'03	-	YTX7B-BS	-	-	1150	GS1150E, S	'83-'86	-	-	SYB14L-B2	-
	KZ400 Deluxe	'77-'79	-	-	YB12A-A*	12N12A-4A-1	1100	GS1100S, Katana	'81-'01	-	-	SYB14L-A2	-
	KZ400-C	'78	-	-	-	12N5.5-4A		GS1100E, S	'80-'83	-	-	YB14L-A2	-
	KZ400-D, H	'74-'79	-	-	YB12A-A*	12N12A-4A-1		GSX1100G, K, L, Katana	'82-'84	YTX14AHL-BS*	-	YB14L-A2	-
	KZ400-aS	'75-'77	-	-	-	12N5.5-4A		GSX-R1100	'86-'92	YTX14AHL-BS*	-	YB14L-A2	-
	S3 Series	'74-'75	-	-	-	12N5.5-4A		GSX-R1100 W	'93-'98	-	YTX12-BS	-	-
350	A7 Series	'66-'71	-	-	YB9-B*	12N9-4B-1		GSX1100F Katana	'88-'93	YTX14AHL-BS*	-	YB14L-B2	-
	F5 Series	'70-'71	-	-	-	6N2-2A-3	1000	GSX1100G	'91-'93	YTX14H-BS*	YTX14-BS	-	-
	F9 Series	'73-'75	-	-	-	6N4B-2A-3		DL1000 V-Strom	'02-'09	YTX14H-BS*	YTX14-BS	-	-
	F9 Series	'72	-	-	-	6N2-2A-3		GS1000	'78-'82	YTX14AHL-BS*	-	YB14L-A2	-
	S2 Series	'72-'73	-	-	-	12N5.5-4A		GSX-R1000	'01-'04	-	YTX12-BS	-	-
305	EX305-B GP	'83	-	-	YB9L-A2	-		GSX-R1000	'05-'09	-	YTX12-BS	-	-
	KZ305 CSR, LTD	'81-'88	-	-	YB10L-A2	-	900	RF900, R, S, ZS	'94-'97	-	YTX9-BS	-	YB14L-A2
250	EX250, Ninja 250R	'08-'09	-	YTX7A-BS	-	6N6-1D-2		850	GS850G, GL	'79-'83	-	-	-
	A1 Series	'66-'71	-	-	YB9-B*	12N9-4B-1		800	VL800 Intruder Volusia, Boulevard C50, T, M50	'01-'08	-	YTX12-BS	-
	EL250, HS	'88-'93	-	-	YB9L-A2	-		VS800 GL, S Intruder, S50	'92-'09	-	-	YB16B-A1	-
	EX250 Ninja	'95-'07	-	YTX7L-BS	-	-		VX800	'90-'93	-	-	YB16B-A	-
	EX250 Ninja	'86-'94	-	-	YB9L-A2	-	750	VZ800 Marauder	'97-'08	YTX14AHL-BS*	-	YB14L-A2	-
	F4 Series	'69-'70	-	-	-	12N5.5-4A		GS750, Katana	'77-'83	-	YTX9-BS	-	-
	F8 Series	'71-'72	-	-	-	6N2-2A-3		GSX750F Katana	'98-'06	YTX14AHL-BS*	-	YB14L-B2	-
	F11 Series	'73-'75	-	-	-	6N4B-2A-3		GSX750F Katana	'89-'97	-	YTX9-BS	-	-
	KE250-B	'77-'79	-	-	-	6N6-1D-2		GSX-R750	'00-'09	-	YTX12A-BS	-	-
	KH250-A	'76	-	-	-	12N5.5-4A		GSX-R750	'96-'99	-	YTX9-BS	-	-
	KL250 Super Sherpa	'00-'09	-	YTX7L-BS	-	6N6-1D-2		GSXR750W	'86-'92	YTX14AHL-BS*	-	YB14L-A2	-
	KL250	'78-'84	-	-	-	-		GSXR750W	'93	-	YTX12-BS	-	-
	KL250-D KLR	'85-'05	-	-	YB4L-A	-		G7750 LeMans	'72-'77	YTX14AHL-BS*	-	YB14L-A2	-
	KLX250S	'06-'09	-	YTX7L-BS	-	-		V5750GLP Intruder	'88-'91	-	-	YB16B-A1	-
	KZ250 CSR, LTD	'80-'83	-	-	YB10L-A2*	12N10-3A-2		GS700E, GS700ES	'85	YTX14AHL-BS*	-	YB14L-A2	-
	S1 Series	'73-'75	-	-	-	12N5.5-4A		GV700GL Madura	'85	YTX14AHL-BS*	-	YB14L-B2	-
200	KZ200-A	'78-'79	-	-	YB10L-B	-		V5700GL Intruder	'85-'87	-	-	YB16B-A1	-
175	F7 Series	'71-'75	-	-	-	6N4-2A-5		DL650 V-Strom	'04-'09	-	YTX12-BS	-	-
	KE175-B	'76-'78	-	-	-	6N6-1D-2		DR650S ER, ES	'94-'95	-	YTX12-BS	-	-
125	BN125 Eliminator	'01-'09	-	-	YB9-B	-		DR650S N, P	'92-'93	-	YTX4L-BS	-	-
	F6 Series	'71-'73	-	-	-	6N4-2A-5		DR650SE	'90-'91	-	YTX9-BS	-	YB5L-B*
	KE125-A	'76-'83	-	-	-	6N6-1D-2		DR650SE (CN)	'96-'97	-	YTX9-BS	-	-
	KS125 Series	'74-'75	-	-	-	6N6-1D-2		DR650SE	'96-'97	-	-	YB10L-B2	-
120	C2SS RoadRunner	'67-'69	-	-	-	6N4-2A-3		GR650 Temptier, X	'83	YTX14AHL-BS*	-	YB14L-A2	-
	C2TR RoadRunner	'67-'69	-	-	-	6N4-2A-3		GS650E	'81-'82	-	-	YB10L-A2	-
100	G3SS Series	'75	-	-	-	6N4-2A-5		GS650 (All)	'81-'83	YTX14AHL-BS*	-	YB14L-A2	-
	G3TR Series	'71	-	-	-	6N4-2A-5		GSX650F	'08-'09	-	YTX9-BS	-	-
	G4TR Series	'73-'75	-	-	-	6N4-2A-3 ††		LS650 Savage, S40	'86-'08	YTX14AHL-BS*	-	YB14L-B2	-
	G4TR Series	'70-'72	-	-	-	6N4-2A-5		SV650	'99-'02	-	YTX12A-BS	-	-
	G5 Series	'74-'75	-	-	-	6N6-1D-2		SV650, S, A, SA	'03-'08	-	YTX12-BS	-	-
	G5 Series	'72-'73	-	-	-	6N4-2A-5		SV650, S	'08-'09	-	YTX12-BS	-	-
	KE100-A	'79-'81	-	-	-	6N6-1D-2		XN85 Turbo	'83	YTX14AHL-BS*	-	YB14L-A2	-
	KE100-A	'76-'78	-	-	-	6N4-2A-5							
	KE100-B	'82-'01	-	-	-	6N6-1D-2							
	KH100-B	'76-'77	-	-	-	6N4-2A-5							
	KM100-A	'79-'81	-	-	-	6N6-1D-2							
	KM100-A	'76-'78	-	-	-	6N4-2A-5							
	KV100-A	'76	-	-	-	6N4-2A-5							
90	G3SS Series	'73-'74	-	-	-	6N4-2A-5							
	G3SS Series	'69-'72	-	-	-	6N4-2A-3 ††							
	G3TR Series	'69-'70	-	-	-	6N4-2A-3 ††							
	MC1 Series	'73-'75	-	-	-	6N4-2A-5							
POLARIS VICTRY													
1731	Vegas, Jackpot, Hammer, Ness, Vision	'08-'09	YTX20HL-BS	-	-	-							
1634	Vegas, Kingpin, Hammer	'08-'09	YTX20HL-BS	-	-	-							

†† G3SS and G3TR models having the engine production #235611 and above, use a 6N4-2A-5 battery.

* See Battery Upgrade Cross Reference Chart on page 9.



MOTORCYCLE

**Recommend
High Performance
Batteries**

for

**• More Power
• Less Maintenance
• Longer Life**

cc	Model	Year	High Performance Maintenance Free	Maintenance Free VRLA	YuMicron	Conventional	cc	Model	Year	High Performance Maintenance Free	Maintenance Free VRLA	YuMicron	Conventional
SUZUKI (continued)							SUZUKI (continued)						
600	GSF600S Bandit	'96-'03	-	YTX9-BS	-	-	100	TS100 Honcho	'78-'81	-	-	-	6N4B-2A
	GSX-R600	'97-'09	-	YTX9-BS	-	-		TS100 Honcho	'73-'77	-	-	-	6N4-2A
	GSX-R600W	'92-'93	-	YTX9-BS	-	-	90	RV90 Rover	'73-'77	-	-	-	6N4B-2
	GSX600F Katana	'98-'06	-	YTX9-BS	-	-		RV90 Rover	'72	-	-	-	6N2-2A-4
	GSX600F Katana SP600	'88-'97	-	-	YB10L-B2	-		TC90	-	-	-	-	6N4-2A
	RF600R, S	'85	-	-	YB5L-B*	12N5-3B		TC90J, TC90R	-	-	-	-	6N2-2A-4
	GS550E, L, M, TX	'94-'96	-	YTX9-BS	-	-	80	Model K10, Model K10P	'68	-	-	-	6N4-2A
550	GS550E, ES, L	'77-'82	-	-	YB10L-A2	-		Sport 80 (Models K11 & K11P)	'68	-	-	-	6N4-2A
	GT550 Indy	'83-'86	-	-	YB10L-B	-		Trail 80 (Models K15 & K15P)	'68	-	-	-	6N4-2A
500	GS500, F	'72-'77	-	-	-	12N11-3A-1	75	TS75 Colt	'75-'77	-	-	-	6N4-2A
	GS500E	'01-'09	-	-	YB10L-B2	-	70	DR-Z70	'08-'09	-	YT4B-BS	-	-
	GT500 Titan	'89-'00	-	-	YB7-A*	12N7-4A	55	Model 31	'68	-	-	-	6N2-2A-4
	SP500	'76-'77	-	-	-	6N4B-2A	50	AC50, AS50	'71	-	-	-	6N4-2A
	T500 Titan	'81-'83	-	-	-	12N7-4A		OR50	'79-'80	-	-	-	6N4B-2A
450	GS450	'68-'75	-	-	YB7-A*	-		Sport 50 (Model M12)	'68	-	-	-	6N4-2A
	GS450	'83-'88	-	-	YB12B-B2	-		TS50	'74	-	-	-	6N4-2A
	GS425, GS425E, L	'80-'82	-	-	YB10L-A2	-	YAMAHA						
425	DR-Z400, E, S	'79	-	-	YB10L-A2	-	1854	Roadliner, Stratoliner	'06-'09	-	YT14B-BS	-	-
400	GN400T, X	'00-'09	-	YT7B-BS	-	6N4B-2A	1700	VMAX	'09	YTZ14S	-	-	-
	GS400	'80-'82	-	-	-	12N7-4A		XV1700A Road Star, Silverado	'04-'09	YTX20HL-BS*	YTX20L-BS	-	-
	GS400X	'77-'78	-	-	YB10L-A2	-	1600	XV1700P Road Star Warrior	'02-'09	-	YT14B-BS	-	-
	GSF400 Bandit	'91-'93	-	YTX9-BS	-	-	1300	FJR1300	'03-'09	YTX20HL-BS*	YTX20L-BS	-	-
	SP400	'80	-	-	-	6N4B-2A		XVZ13 Royal Star/Venture (All)	'96-'09	YTX20HL-BS*	YTX20L-BS	-	-
	TS400 Apache	'76-'77	-	-	-	6N4B-2A		XVZ13 Venture/Royale	'86-'93	YTX24HL-BS*	-	SY50-N18L-AT	-
	TS400 Apache	'72-'75	-	-	YB5L-B*	12N5-3B	1200	XJR1300(EU)	'07-'09	YTZ14S	-	-	-
380	GT380 Sebring	'72-'77	-	-	YB7-A*	12N7-4A		FJ1200 (All)	'91-'93	YTX14H-BS*	YTX14-BS	-	-
370	SP370	'78-'79	-	-	-	6N4B-2A		FJ1200	'86-'90	YTX14AHL-BS*	-	YB14L-A2	-
350	DR350S	'90-'96	-	YTX4L-BS	-	-		VMX12 V-Max	'85-'07	-	-	YB16AL-A2	-
	DR350SE	'94-'99	-	YTX7L-BS	-	-	1100	XVZ12 Venture/Royale	'83-'85	YTX24HL-BS*	-	SY50-N18L-AT	-
	T350 Series	'79	-	-	YB5L-B*	12N5-3B		FJ1100	'84-'85	YTX14AHL-BS*	-	YB14L-A2	-
305	Scramble TC305	'69	-	-	YB5L-B*	12N5-3B		XJ1100 Maxim	'82	YTX24HL-BS*	-	SY50-N18L-AT	-
	T305	'69	-	-	YB5L-B*	12N5-3B		XS1100 (All)	'78-'81	YTX24HL-BS*	-	Y50-N18L-A-CX*	Y50-N18L-A
300	GS300L	'82-'85	-	-	YB12B-B2	-		XJ9100 Virago (All)	'86-'99	YTX24HL-BS*	-	Y50-N18L-A-CX*	Y50-N18L-A
250	DR250S	'90-'92	-	YTX4L-BS	-	-	1000	XVS1100 V-Star (All)	'99-'09	-	YT14B-BS	-	-
	DR250S EP, ER, ES	'93-'95	-	YTX7L-BS	-	-		FZR1000	'91-'95	YTX14H-BS*	YTX14-BS	-	-
	DR-Z250	'01-'07	YTZ7S	-	-	-		FZR1000	'87-'90	YTX14AHL-BS	-	YB14L-A2	-
	GN250	'82-'88	-	-	YB10L-A2	-		FZS1000 FZ1	'06-'09	YTZ14S	-	-	-
	GS250T	'80-'81	-	-	YB5L-B*	12N5-3B		FZS1000 FZ1	'01-'05	-	YT14B-BS	-	-
	GT250 Hustler	'73-'77	-	-	-	-		GTS1000	'93-'94	-	YTX14-BS	-	-
	GZ250	'99-'09	-	YTX7L-BS	-	-		XJ1000 Virago	'84-'85	YTX24HL-BS*	-	Y50-N18L-A-CX*	Y50-N18L-A
	Model T20	'69	-	-	YB5L-B*	12N5-3B		YZF-R1	'98-'03	-	YT12B-BS	-	-
	SP250	'82-'85	-	-	-	-		YZF-R1	'04-'09	YTZ10S	-	-	-
	Scrambler TC250	'69	-	-	YB5L-B*	12N5-3B		YZF1000R	'97	YTX14H-BS*	YTX14-BS	-	-
	T250, T250-II, T250J, T250R	'72	-	-	-	6N2-2A-4	920	XV920 Virago	'82	YTX24HL-BS*	-	SY50-N18L-AT	-
	TS250 Savage	'73-'81	-	-	-	-		XV920MM Midnight Virago	'83	YTX24HL-BS*	-	Y50-N18L-A-CX*	Y50-N18L-A
	TS250 Savage	'69-'72	-	-	-	-		XV920R Virago	'81-'83	YTX24HL-BS*	-	Y50-N18L-A-CX*	Y50-N18L-A
200	DR200SE	'96-'08	-	YTX7L-BS	-	-	900	XJ900R Seca	'83	YTX14AHL-BS*	-	YB14L-A2	-
	SP200	'86-'88	-	-	YB4L-B	-	850	TDM850	'92-'93	-	YTX12-BS	-	-
	T200, TC200	-	-	-	YB5L-B*	12N5-3B		XS850 (All)	'80-'81	YTX14AHL-BS*	-	YB14L-A2	-
185	GT185 Adventurer	'73-'77	-	-	-	12N11-3A-1	750	FZ750, FZR750	'85-'88	YTX14AHL-BS*	-	YB16L-B	-
	TC185 Ranger	'74-'77	-	-	-	12N11-3A-1		TX750	'73-'74	YTX20HL-BS*	YTX20L-BS*	YB16L-B	-
	TS185 Sierra	'77-'81	-	-	-	6N4B-2A		XJ750 Maxim	'82-'83	-	-	SYB14L-A2	-
	TS185 Sierra	'71-'76	-	-	-	6N4-2A		XJ750M Midnight Maxim	'83	YTX14AHL-BS*	-	YB14L-A2	-
125	DR125, SE, SES	'94-'96	-	YTX7L-BS	-	-		XJ750R Seca	'81-'83	-	-	SYB14L-A2	-
	GN125, E	'91-'96	-	-	YB7-A	-		XS750 (All)	'77-'79	YTX14AHL-BS*	-	YB14L-A2*	12N14-3A
	GN125, E	'82-'83	-	-	YB7-A	-		XV750 Virago (All)	'81-'96	-	-	YB16AL-A2	-
	RV125 SE, R	'94	-	YTX7L-BS	-	-		YZF750R	'94-'98	-	YTX12-BS	-	-
	RV125 Tracker	'73-'77	-	-	-	6N4-2A		YZF-R7	'99	-	YT9B-BS	-	-
	SP125	'86-'88	-	-	-	6N4-2A		FZ700, Fazer	'86-'87	YTX14AHL-BS*	-	YB14L-A2	-
	SP125	'82-'83	-	-	-	6N4B-2A		XJ700 Maxim, XJ700X	'85-'86	YTX14AHL-BS*	-	YB14L-A2	-
	TC125 Prospector	'73-'77	-	-	-	6N4-2A		XV700 Virago	'84-'87	-	-	YB16AL-A2	-
	TS125 Duster	'71-'81	-	-	-	6N4B-2A	650	TX650	'74	YTX14AHL-BS*	-	YB14L-A2	12N14-3A
120	B120P	-	-	-	-	6N4-2A		TX650	'73	-	-	YB12A-A*	12N12A-4A-1
	TC120, TC120-II, TC120R	'71	-	-	-	6N4-2A		XJ650 (All)	'80-'83	-	-	YB12A-A*	12N12A-4A-1
105	B105P	-	-	-	-	6N4-2A		XS1	'70-'71	-	-	-	12N5-5-3B
100	A100 Go-fer	'76-'77	-	-	-	6N4-2A		XS2	'72	-	-	YB12A-A*	12N12A-4A-1
	A100 Go-fer	'69	-	-	-	6N4-2A		XS650	'75-'83	YTX14AHL-BS*	-	YB14L-A2*	12N14-3A
	B100P	-	-	-	-	6N4B-2A		XVS650 V-Star (All)	'98-'09	-	YT12B-BS	-	-
	SP100	'83	-	-	-	6N4-2A		FJ600	'84-'85	-	-	YB12A-A*	12N12A-4A-1
	Scrambler AC100	'69	-	-	-	6N4-2A		FZ6	'05-'09	-	YT12B-BS	-	-
	Sport AS100	'69	-	-	-	6N4-2A		FZ600	'86-'88	-	-	YB12A-A*	12N12A-4A-1
	TC100 Blazer	'73-'77	-	-	-	6N4-2A				-	-	-	12N12A-4A-1

* See Battery Upgrade Cross Reference Chart on page 9.

**Recommend
High Performance
Batteries**

for

- More Power
- Less Maintenance
- Longer Life

MOTORCYCLE



cc	Model	Year	High Performance Maintenance Free	Maintenance Free VRLA	YuMicron	Conventional	cc	Model	Year	High Performance Maintenance Free	Maintenance Free VRLA	YuMicron	Conventional
YAMAHA (continued)							YAMAHA (continued)						
600	FZR600/R	'89-'99	-	-	YB12AL-A2	-	250	XV250 Route 66	'88-'90	-	-	YB10L-A2 *	12N10-3A-2
	SRX600	'86	-	-	YB5L-B *	12N5-3B	230	TTR230E	'06-'07	YTZ7S *	YTX5L-BS	-	-
	XJ600S Seca II	'92-'98	-	YTX9-BS	-	-	225	TTR225	'99-'05	-	-	YB7B-B	-
	XT600	'84-'89	-	-	YB5L-B	-		XT225	'01-'07	YTZ7S	-	-	-
	XT600E	'90-'95	-	YTX9-BS	-	-		XT225 Serow	'92-'00	-	YTX7L-BS	-	-
	YX600 Radian	'86-'90	-	-	YB12A-A *	12N12A-4A-1	200	BW200E Big Wheel (Electric Start)	'86-'88	-	-	YB7C-A	-
	YZF-R6 (Excl. R6S)	'06-'09	YTZ10S	-	-	-		CS3B, CS3C	'70-'71	-	-	YB9L-A2	-
	YZF-R6, R6S	'01-'07	-	YT9B-BS	-	-		CS5	'72	-	-	YB9L-A2	-
	YZF-R6	'99-'00	-	YT12B-BS	-	-		RD200	'74-'76	-	-	YB9L-A2	-
	YZF600R	'95-'07	-	YTX12-BS	-	-		TW200	'87-'07	-	-	YB7C-A	-
550	XJ550 Maxim, R Seca	'81-'83	-	-	YB12A-A *	12N12A-4A-1		XT200	'82-'83	-	-	-	6N4A-4D
	XT550	'82-'83	-	-	YB5L-B *	12N5-3B		YCS1	'68	-	-	YB9L-A2	-
	XZ550R Vision	'82-'83	YTX14AHL-BS *	-	YB14L-A2	-	185	SR185 Exciter	'81-'82	-	-	YB7L-B	-
535	XV535 Virago	'87-'99	-	-	YB12AL-A2	-	175	CT1, CT1B, CT1C 175 Enduro	'69-'71	-	-	-	6N2-2A-3
500	SR500	'78-'81	-	-	YB7L-B	12N7-3B		CT2, CT3 175 Enduro	'72-'73	-	-	-	6N4-4D
	TX500	'73-'74	YTX14AHL-BS *	-	YB14L-A2 *	12N14-3A		DT175 Enduro	'78-'81	-	-	-	6N6-3B-1
	XS500	'75-'78	YTX14AHL-BS *	-	YB14L-A2 *	12N14-3A		DT175 Enduro	'74-'76	-	-	-	6N4B-2A-3
	XT500	'76-'81	-	-	YB12A-A *	6N6-3B-1		DT175 Enduro	'69	-	-	-	12N5.5-3B
	XV500 Virago	'83	-	-	-	12N12A-4A-1	125	AS2C	'69	-	-	-	12N7-3B
450	WR450F	'03-'07	YTZ7S	-	-	-		AT1E, AT1B, AT1C 125 Enduro	'69-'71	-	-	YB7L-B *	12N7-3B
400	DT400 Enduro	'77-'78	-	-	-	6N6-3B-1		AT2, AT3 125 Enduro	'72-'73	-	-	YB7L-B *	12N7-3B
	DT400 Enduro	'75-'76	-	-	-	6N4B-2A-3		DT125 Enduro	'74-'81	-	-	YB7L-B *	12N7-3B
	FZR400 (All)	'88-'90	-	-	YB12AL-A2	-		RD125	'75-'76	-	-	-	12N5.5A-3B
	RD400	'76-'79	-	-	-	12N5.5A-3B		TTR125E/LE Electric Start	'03-'07	-	YTX4L-BS	-	-
	XS400 (All)	'80-'83	-	-	YB12A-A *	12N12A-4A-1		XT125	'82-'83	-	-	-	6N4A-4D
360	DT360 Enduro	'74	-	-	-	6N4B-2A-3		YA6	'64-'66	-	-	YB10L-B	-
	RT1, RT1B 360 Enduro	'70-'71	-	-	-	6N2-2A-3		YAS1/C	'68	-	-	-	12N5.5-3B
	RT2, RT3 360 Enduro	'72-'73	-	-	-	6N4-2A-5	100	DT100 Enduro	'77-'83	-	-	-	6N4-2A-5
	XS360	'76-'78	-	-	YB12A-A *	6N4-2A-5		DT100 Enduro	'74-'76	-	-	-	6N4B-2A-3
	XS360-2	'77	-	-	YB7L-B *	12N7-3B		L5T, L5TA	'69-'70	-	-	YB7L-B *	12N7-3B
350	BW350 Big Wheel	'87-'88	-	-	YB12B-B2	-		LS2	'72	-	-	-	12N5.5A-3B
	R3	'69	-	-	YB5L-B *	12N5-3B		LT2, LT3 100 Enduro	'72-'73	-	-	-	6N4A-4D
	R5, R5B, R5C	'70-'72	-	-	-	12N5.5A-3B		RS100	'75-'76	-	-	YB7L-B *	6N4A-4D
	RD350	'73-'75	-	-	-	12N5.5A-3B	90	YL2C/CM	'68	-	-	-	12N7-3B
	RZ350	'84-'85	-	-	-	12N5.5-3B		HS1, HS1B	'70-'71	-	-	-	12N5.5-3B
	XT350	'85-'00	-	-	YB3L-B	-		HT1, HT1B 90 Enduro	'70-'71	-	-	-	6N2-2A-3
	YR2/C	'68	-	-	-	12N5.5-3B		TTR90E Electric Start	'03-'07	-	YT4B-BS	-	-
250	DS6B, DS6C	'69-'70	-	-	YB5L-B	12N5-3B		DT80 Mini Enduro	'81-'83	-	-	-	6N4-2A-5
	DS7	'72	-	-	-	12N5.5A-3B	80	G6S, G6SB	'70-'71	-	-	-	6N4A-4D
	DT1 250 Enduro	'68	-	-	-	6N2-2A-3		G7S	'72	-	-	-	6N4A-4D
	DT1B, DT1C, DT1E 250 Enduro	'69-'71	-	-	-	6N4-2A-5		GT1 Mini Enduro	'73	-	-	-	6N4-2A-5
	DT2 250 Enduro	'72	-	-	-	6N6-3B-1		GT80 Mini Enduro	'74-'80	-	-	-	6N4-2A-5
	DT250 Enduro	'77-'79	-	-	-	6N4B-2A-3		LB80 Chappy	'76-'78	-	-	-	6N4-2A-5
	DT250 Enduro	'74-'76	-	-	-	6N4-2A-5		YG1	'62-'66	-	-	-	6N4A-4D
	DT3 250 Enduro	'73	-	-	-	12N5.5A-3B		YG5T, YG5S	'68-'69	-	-	YB7L-B *	12N7-3B
	RD250	'73-'75	-	-	-	12N12A-4A-1	60	JT2 Mini Enduro	'72	-	-	-	6N2-2A-3
	SR250 Exciter	'80-'82	-	-	YB12A-A *	12N12A-4A-1		RD60	'73-'75	-	-	-	6N4A-4D
	SRX250	'87	-	-	YB12A-A *	12N12A-4A-1	50	DT50 Enduro	'88-'90	-	-	-	6N4B-2A-3
	TTR250	'99-'06	-	YT7B-BS	-	-		LB50P Chappy	'78-'82	-	-	-	6N4-2A-5
	WR250X, R	'08-'09	YTZ7S	-	-	-		LC50 Champ	'80-'81	-	-	-	6N4-2A-5
	WR250F	'08-'09	YTZ7S *	YTX5L-BS	-	-		MJ50 Towny	'82	-	-	-	6N4-2A-5
	WR250F	'03-'07	YTZ7S *	YTX5L-BS	-	-		QT50 Yamahopper	'79-'87	-	-	-	6N4-2A-5
	XT250	'08-'09	YTZ7S	-	-	-		RX50 Special	'83-'84	-	-	-	6N4-2A-5
	XT250	'84	-	-	YB3L-B	-		TTR50E	'06-'07	-	YT4B-BS	-	-
	XT250	'80-'83	-	-	-	6N6-3B-1		YSR50	'87-'92	-	-	-	6N4-2A-5
	XV250 Virago	'95-'03	-	-	YB10L-A2 *	12N10-3A-2							

SCOOTER



cc	Model	Year	High Performance Maintenance Free	Maintenance Free VRLA	YuMicron	Conventional	cc	Model	Year	High Performance Maintenance Free	Maintenance Free VRLA	YuMicron	Conventional
APRILIA							DRR						
500	Scarabeo	'09	-	YTX12-BS	-	-	All Models			-	YTX4L-BS	-	-
250	Sport City	'09	-	YTX12-BS	-	-	E-TON						
200	Scarabeo	'09	-	-	YB12AL-A	-	50	Beamer 50	'00-'03	YTZ7S *	YTX5L-BS	-	-
150	Mojito	'09	-	YTX7L-BS	-	-							
100	Scarabeo ST	'09	-	-	YB9-B	-							

* See Battery Upgrade Cross Reference Chart on page 9.



SCOOTER

**Recommend
High Performance
Batteries**

for

**• More Power
• Less Maintenance
• Longer Life**

cc	Model	Year	High Performance Maintenance Free	Maintenance Free VRLA	YuMicron	Conventional	cc	Model	Year	High Performance Maintenance Free	Maintenance Free VRLA	YuMicron	Conventional
HONDA							PIAGGIO						
600	FSC600 Silver Wing	'02-'09	YTZ12S	-	-	-	500	MP3 500	'08-'09	YTX14H-BS *	YTX14-BS	-	-
250	CH250 Elite	'85-'90	-	YTX12-BS	-	-	400	MP3 400	'08-'09	YTX14H-BS *	YTX14-BS	-	-
	CN250 Helix	'93-'07	-	YTX12-BS	-	-	250	MP3 250	'08-'09	YTX14H-BS *	YTX14-BS	-	-
	CN250 Helix	'86-'87	-	YTX12-BS	-	-	500	BV500	'08-'09	YTX14H-BS *	YTX14-BS	-	-
	NSS250 Reflex	'01-'09	YTZ12S	-	-	-	460	X9	'09	YTX14H-BS *	YTX14-BS	-	-
	PS250 Big Ruckus	'05-'06	YTZ12S	-	-	-	250	BV250	'08-'09	YTX14H-BS *	YTX14-BS	-	-
150	CH150 Elite	'87	-	YTX9-BS	-	-	150	FLY150	'09	-	-	YB9-B	-
	CH150 Elite Deluxe	'85-'86	-	-	YB9-B	-	50	FLY 50	'09	-	-	YB9-B	-
	FES150	-	-	YTR9-BS	-	-		Typhoon	'09	-	-	YB9-B	-
125	CH125 Elite	'84	-	-	YB9-B	-	SYM						
	FES125	-	-	YTR9-BS	-	-	200	HD	'09	-	YTX9-BS	-	-
	NH125 Aero	'84	-	-	YB5L-B	-	50	Mio	'09	YTZ7S *YTX5L-BS	-	-	
	Pantheon 125	-	-	YTR9-BS	-	-		DD	'09	-	YTX4L-BS	-	-
80	CH80 Elite	'93-'09	YTZ7S *	YTX5L-BS	-	-	SUZUKI						
	NH80 Aero	'85	YTZ7S *	YTX5L-BS	-	-	650	AN650 Burgman	'03-'09	YTX14H-BS*	YTX14-BS	-	-
	NH80MD Aero	'83-'84	-	-	YB5L-B	-	400	AN400 Burgman	'03-'09	YT12A-BS	-	-	-
50	CHF50 Metropolitan, II, SP	'02-'09	YTZ7S	-	-	-	50	F50, F50R	'71	-	-	-	6N4-2A
	NB50 Aero	'85-'87	-	YTX4L-BS	-	-		FA50 Shuttle	'80-'91	-	-	-	6N2-2A-4
	NB50M Aero	'83-'84	-	-	YB4L-B	-		FS50, FZ50	'79-'83	-	-	-	6N4-2A
	NN50MD Gyro	'84	-	-	YB4L-B	-	YAMAHA						
	NPS50, S Ruckus	'03-'09	YTZ7S	-	-	-	500	SP500 T-Max	'09	YTZ10S	-	-	-
	NQ50 Spree, 50D SS	'86-'87	-	YTX4L-BS	-	-	400	YP400 Majesty	'04-'07	-	YTR9-BS	-	-
	NQ50 Spree	'84-'85	-	-	YB4L-B	-	250	Morphous	'06-'07	YTZ10S	-	-	-
	P50 Little Honda	'67-'68	-	-	-	-	200	XC200 Riva	'87-'91	-	-	YB10L-B2	-
	PA50I Moped, PA50II	'78-'83	-	-	-	-	180	XC180 Riva	'83-'85	-	-	YB10L-B	-
	SA50 Elite LX, S, SR	'88-'01	-	YTX4L-BS	-	-	125	XC125 Riva	'85-'01	-	-	YB7C-A	-
	SB50 (All)	'88-'90	-	YTX4L-BS	-	-		Zuma 125	'04-'09	-	YTX7A-BS	-	-
	SE50 Elite (All)	'87	-	YTX4L-BS	-	-	80	CV80 Riva	'83-'87	-	YTX7A-BS	-	-
	TG50 Gyro S (All)	'85-'86	-	YTX4L-BS	-	-	50	CA50 Riva	'83-'86	-	-	6YB11-2D	6N11-2D
HYOSUNG								CE50 Riva Jog	'86-'87	-	-	6YB8L-B	-
250	NS3-250	'09	-	YTX9-BS	-	-		CG50 Riva	'88-'91	-	-	YB4L-B	-
100	EZ100	All Years	YTZ7S *	YTX5L-BS	-	-		CV50 Riva	'84	-	-	6YB8L-B	-
50	SB50 Super Cab, SD50 Sense, SF50 Prima, Rally, Sense	All Years	-	YTX4L-BS	-	-		CW50 Zuma	'89-'90	-	-	YB4L-B	-
KYMCO								CW50 Zuma II	'97-'01	-	-	YB4L-B	-
500	Xciting 500i	'09	YTX14H-BS *	YTX14-BS	-	-		CY50 Riva Jog	'92-'01	-	YTX4L-BS	-	-
400	Xciting 400i	'09	-	YTX12-BS	-	-		SH50 Riva Razz	'87-'01	-	-	YB4L-B	-
250	People 250	'09	-	YTX12-BS	-	-		XC50 Vino Classic	'06-'07	YTZ7S *	YTX5L-BS	-	-
150	People 150	'09	-	YTX7A-BS	-	-		XF50W (C3)	'07	YTZ7S *	YTX5L-BS	-	-
125	People 125	'09	-	YTX7A-BS	-	-		YJ50R Vino/Vino Classic	'01-'05	-	YTX5L-BS	-	-
50	Super 8,9	'09	YTZ7S *	YTX5L-BS	-	-		YW50A Zuma	'02-'03	YTZ7S *	YTX5L-BS	-	-
	People	'09	YTZ7S *	YTX5L-BS	-	-							
	Agility 50	'09	YTZ7S *	YTX5L-BS	-	-							



UTILITYVEHICLE

cc	Model	Year	High Performance Maintenance Free	Maintenance Free VRLA	YuMicron	Conventional	cc	Model	Year	High Performance Maintenance Free	Maintenance Free VRLA	YuMicron	Conventional
ARCTIC CA							POLARIS						
700	Prowler 700	'09	YTX24HL-BS *	-	Y50N18L-A-CX	-	800	RZR	'08-'09	YTX20HL-BS	-	-	-
650	Prowler 650	'06-'09	YTX24HL-BS *	-	Y50N18L-A-CX	-	700	Ranger 6x6	'06-'09	-	YIX30L	-	-
KAWASAKI							500	Ranger 6x6, 4x4	'98-'09	-	YIX30L *	YB30L-B	-
950	KAF950, Mule 2510, 3010 Diesel	-	Not available	-	-	-	425	Ranger 2x4	'02-'03	-	YIX30L *	YB30L-B	-
750	Teryx All Models	'08-'09	Not available	-	-	-	SUZUKI						
620	KAF620, Mule 3010 4x4	-	-	-	-	-	620	QUV620F	'05	YTX20HL-BS *	YTX20L-BS	-	-
	Advantage Classic	'03-'07	YTX20HL-BS *	YTX20L-BS	-	-	YAMAHA						
	KAF620, Mule 3000, 3010, 3020	-	YTX20HL-BS *	YTX20L-BS	-	-		Rhino	All Years	Not available	-	-	-
	KAF620, Mule 2500, 2510, 2520	-	YTX20HL-BS-PW *	YTX20L-BS	YB16CL-B	-							
	KAF620F, Mule 4010 4x4	'-09	YTX20HL-BS *	YTX20L-BS	-	-							
	Mule 4010 Trans4x4, Diesel, Mule4000	-	Not available	-	-	-							
540	KAF540, Mule 2010, 2020, 2030	-	YTX20HL-BS-PW *	-	YB16CL-B	-							
450	KAF450, Mule 1000	-	YTX20HL-BS-PW *	-	YB16CL-B	-							
400	KAF400, Mule 600, 610	'05-'07	YTX14AH-BS *	-	YB14A-A2	-							
300	KAF300, Mule 500, 520, 550	-	YTX14AH-BS *	-	YB14A-A2	-							

* See Battery Upgrade Cross Reference Chart on page 9.

Recommend High Performance Batteries

for

- More Power
- Less Maintenance
- Longer Life

ATV



cc	Model	Year	High Performance Maintenance Free	Maintenance Free VRLA	YuMicron	Conventional	cc	Model	Year	High Performance Maintenance Free	Maintenance Free VRLA	YuMicron	Conventional	
AEON (BENZAI)							HONDA (continued)							
50	Cobra/CX-Sport 50	All	-	YTX4L-BS	-	-	400	TRX400FW Foreman	'95-'03	YTX14H-BS *	YTX14-BS	-	-	
90	Cobra/CX-Sport 90	All	-	YTX4L-BS	-	-	420	TRX420 Fourtrax Rancher 4x4	'09	YTX14H-BS *	YTX14-BS	-	-	
100	Cobra/CX-Sport 100	All	-	YTX4L-BS	-	-	450	TRX450 Fourtrax Foreman S, ES	'98-'04	YTX14H-BS *	YTX14-BS	-	-	
ARCTIC CA							JOHN DEERE							
50	DVX50	'06-'09	YTZ7S *	YTX5L-BS	-	-	All Models							
90	All Models	'06	-	YTX4L-BS	-	-	All Years	YTX20HL-BS-PW *	-	-	YB16CL-B	-		
90	DVX90	'06-'09	YTZ7S *	YTX5L-BS	-	-	KASEA							
250	All Models	'05	YTX14AH-BS *	-	YB14L-A2	-	50	Mini Skyhawk	All	YTZ7S *	YTX4L-BS	-	-	
	DVX250, 2x4	'06	-	YTX12-BS	-	-		Skyhawk 50	All	-	YTX5L-BS	-	-	
300	All Models	All	YTX14AH-BS *	-	YB14L-A2	-	65	KS, KU Models	All	-	YTX7A-BS	-	-	
366	366	All	YTX14AH-BS *	-	YB14-A2	-	90	KS, KU Models	All	-	YTX7A-BS	-	-	
400	All Models	All	YTX14AH-BS *	-	YB14-A2	-		Skyhawk 90	All	YTZ7S *	YTX5L-BS	-	-	
	DVX400	All	-	YTX9-BS	-	-	125	KS, KU Models, Adventure Buggy	All	-	YTX7A-BS	-	-	
	TRV400	'09	YTX14AH-BS *	-	YB14-A2	-	150	Skyhawk 150, Adventure Buggy	All	-	YTX7A-BS	-	-	
500	All Models	All	YTX14AH-BS *	-	YB14-A2	-	170	Skyhawk 170	All	-	YTX7A-BS	-	-	
650	4x4 Automatic	'04-'06	YTX14AH-BS *	-	YB14-A2	-	250	Skyhawk 250	All	-	YTX7A-BS	-	-	
	650H1, TBX650	'09	YTX14AH-BS *	-	YB14-A2	-	KAWASAKI							
700	TRV700	'09	YTX14AH-BS *	-	YB14-A2	-	50	KFX50	'07-'09	YTZ7S *	YTX5L-BS	-	-	
	700H1	'09	YTX20H-BS	-	-	-	80	KSF80-A (KFX80)	'03-'05	YTZ7S *	YTX5L-BS	-	-	
1000	Thundercat	'09	YTX20H-BS	-	-	-	90	KFX90	'07-'09	YTZ7S *	YTX5L-BS	-	-	
BRP(Can-Am)							400							
50	DS50, Quest	'02-'06	-	YTX4L-BS	-	-	110	KLF110-B Mojave	'87-'88	-	-	YB9L-A2	-	
90	DS90, DS90F, Quest	'02-'06	-	YTX4L-BS	-	-	185	KLF185-A Bayou	'85-'88	-	-	YB10L-B	-	
200	Rally	'02-'06	YTX14AH-BS *	-	YB14A-A2	-	200	KLT200-A, C	'81-'84	-	-	YB10L-B	-	
250	DS250	'06-'09	-	YTX12-BS	-	-		KLT200-B, C	'83	-	-	YB12A-A	-	
330	Outlander 330	'04-'05	-	YTX15L-BS	-	-	220	KLF220-A Bayou	'88-'02	-	-	YB10A-A2	-	
400	Outlander 400	'03-'04	-	YTX15L-BS	-	-		KLF220-A Bayou (CN)	'92-'02	YTX14AH-BS *	-	YB14A-A2	-	
	Outlander 400, XT, MAX	'04-'09	YTX20HL-BS *	-	-	-	250	KLF250-A Bayou	'03-'09	-	-	YB10A-A2	-	
450	DS450	'09	-	YTX15L-BS	-	-		KLF250-A Bayou (CN)	'03-'05	YTX14AH-BS *	-	YB14A-A2	-	
500	Traxter (All Models), Quest	'99-'05	YTX20HL-BS-PW *	-	YB16CL-B	-		KLT250-A	'82-'83	-	-	YB12A-A	-	
	Traxter (All Models), Quest(Opt)	'02-'05	YTX24HL-BS *	-	Y50-N18L-A-CX*	Y50-N18L-A		KLT250-C Prairie	'84-'85	-	-	YB10L-B	-	
	Outlander, MAX, Renegade	'09	YTX20HL-BS *	-	Y50-N18L-A-CX*	Y50-N18L-A		KLT250-C Prairie	'84-'85	-	-	YB10L-B	-	
650	DS650	'00-'06	-	YTX15L-BS	-	-	300	KEF300-A Lakota	'95-'00	YTX14AH-BS *	-	YB14A-A2	-	
	Quest	'02-'05	YTX20HL-BS-PW *	-	YB16CL-B	-		KEF300-A Lakota Sport	'01-'03	YTX14AH-BS *	-	YB14A-A2	-	
	Quest (Opt)	'02-'05	YTX24HL-BS *	-	Y50-N18L-A-CX*	Y50-N18L-A		KEF300-B Lakota Sport	'01-'03	YTX14AH-BS *	-	YB14A-A2	-	
	Outlander, MAX	'09	YTX20HL-BS *	-	-	-		KLF300-A Bayou	'86-'87	YTX20HL-BS-PW *	-	YB16CL-B	-	
660	Outlander 660 EFI	'06	YTX20HL-BS *	-	-	-		KLF300-B Bayou	'88-'04	YTX14AH-BS *	-	YB14A-A2	-	
800	Outlander 800 EFI, Renegade	'06-'09	YTX20HL-BS *	-	-	-		KLF300-B Bayou (CN)	'92-'99	YTX20HL-BS-PW *	-	YB16CL-B	-	
E-TON							300							
50	All models	'04-'05	YTZ7S *	YTX5L-BS	-	-		KLF300-C Bayou 300 4x4	'89-'04	YTX14AH-BS *	-	YB14A-A2	-	
	AXL, TXL, NXL, RXL	'99-'03	-	YTX4L-BS	-	-		KLF300-C Bayou 300 4x4 (CN)	'92-'05	YTX20HL-BS-PW *	-	YB16CL-B	-	
90	All models	'04-'05	YTZ7S *	YTX5L-BS	-	-		KVF300-A Prairie 300, 4x4	'99-'02	YTX14AH-BS *	-	YB14A-A2	-	
	AXL, TXL, NXL, RXL	'99-'03	-	YTX4L-BS	-	-		KVF300-A Prairie 300, 4x4 (CN)	'99-'01	YTX20HL-BS-PW *	-	YB16CL-B	-	
	DXL90 Sierra	'99-'03	-	YTX4L-BS	-	-		KVF300-B Prairie 300, 4x4	'99-'02	YTX14AH-BS *	-	YB14A-A2	-	
150	CXL150 Yukon II	'00-'03	-	YTX9-BS	-	-		KVF300-B Prairie 300, 4x4 (CN)	'99-'02	YTX20HL-BS-PW *	-	YB16CL-B	-	
	YXL150 Yukon	'00-'03	-	YTX9-BS	-	-		KVF300-C Prairie 300, 4x4 (CN)	'99-'02	YTX14AH-BS *	-	YB14A-A2	-	
HONDA							400							
90	TRX90EX	'06-'09	YTZ7S *	YTX5L-BS	-	-		KLF400-B Bayou 400 4x4	'93-'00	YTX20HL-BS-PW *	-	YB16CL-B	-	
125	ATC125M	'86-'87	-	YTX12-BS	-	-		KSF400-A (KFX400)	'03-'06	-	YTX9-BS	-	-	
	ATC125M	'84-'85	-	-	YB9A-A	-		KVF400-A Prairie 400 4x4	'97-'00	YTX14AH-BS *	-	YB14A-A2	-	
	TRX125 Fourtrax	'87-'88	-	YTX9-BS	-	-		KVF400-A Prairie 400 4x4 (CN)	'97-'00	YTX20HL-BS-PW *	-	YB16CL-B	-	
	TRX125 Fourtrax	'85-'86	-	-	YB9A-A	-		KVF400-B Prairie 400 4x4	'98-'00	YTX14AH-BS *	-	YB14A-A2	-	
200	ATC200 Big Red	'82-'84	YTX14AH-BS *	-	YB14A-A2	-		KVF400-B Prairie 400 4x4 (CN)	'98-'00	YTX20HL-BS-PW *	-	YB16CL-B	-	
	ATC200M	'84-'85	YTX14AH-BS *	-	YB14A-A2	-		KVF400-C Prairie 400, 4x4	'99-'02	YTX14AH-BS *	-	YB14A-A2	-	
	TRX200 Fourtrax	'90-'96	-	YTX12-BS	-	-		KVF400-C Prairie 400, 4x4 (CN)	'99-'02	-	KMX14-BS K	-	-	
	TRX200 Fourtrax	'84	YTX14AH-BS *	-	YB14A-A2	-		KVF400-D Prairie 400, 4x4 (CN)	'99-'01	YTX14AH-BS *	-	YB14A-A2	-	
	TRX200SX Fourtrax	'86-'88	-	YTX12-BS	-	-		450	KFX450R	'08-'09	-	YTX7L-BS	-	
	TRX200SX Fourtrax	'86-'88	-	YTX12-BS	-	-		650	4x4 Advantage Classic	'02-'03	-	KMX14-BS K	-	
250	ATC250ES Big Red	'85-'87	-	YTX12-BS	-	-		KVF650 Brute Force	'02-'09	-	KMX14-BS K	-	-	
	ATC250SX	'85-'87	-	YTX12-BS	-	-		700	KVF650-A, B, D Prairie 700, 4X4	'04-'06	-	KMX14-BS K	-	
	TRX250 EX, TE, TM	'01-'09	-	YTX9-BS	-	-		KFX700	'03-'09	-	KMX14-BS K	-	-	
	TRX250 Fourtrax	'85-'87	-	YTX12-BS	-	-		KVF700-A, B, D Prairie 700, 4x4	'04-'06	-	KMX14-BS K	-	-	
	TRX250 Fourtrax Recon	'97-'09	-	YTX12-BS	-	-		KVF750 Brute Force	'05-'09	-	KMX14-BS K	-	-	
	TRX250 Recon, ES	'97-'03	-	YTX12-BS	-	-		KTM						
300	TRX300 Fourtrax	'88-'00	YTX14H-BS *	-	YB14A-A2	-	450	SX ATV	'08-'09	YTZ7S*	YTX5L-BS	-	-	
	TRX300EX	'93-'09	-	YTX9-BS	-	-		XC ATV	'08-'09	YTZ7S*	YTX5L-BS	-	-	
	TRX300FW Fourtrax 4x4	'88-'00	YTX14H-BS *	-	YB14A-A2	-	505	SX ATV	'08-'09	YTZ7S*	YTX5L-BS	-	-	
	FL350R Odyssey	'85	-	YTX12-BS	-	-		XC ATV	'08-'09	YTZ7S*	YTX5L-BS	-	-	
	TRX350 Rancher	'00-'06	YTX14H-BS *	-	-	-		450						
	TRX350, D Fourtrax 4x4	'86-'89	YTX14H-BS *	-	-	-		SX ATV	'08-'09	YTZ7S*	YTX5L-BS	-	-	
	FL400R Pilot	'89-'90	YTX14H-BS *	-	-	-		XC ATV	'08-'09	YTZ7S*	YTX5L-BS	-	-	
400	TRX400 Rancher AT	'04-'06	YTX14H-BS *	-	-	-		XC ATV	'08-'09	YTZ7S*	YTX5L-BS	-	-	
	TRX400EX, Fourtrax, Sportrax	'99-'09	-	YTX9-BS	-	-								

* See Battery Upgrade Cross Reference Chart on page 9.
 K Available at Kawasaki dealers only.



ATV

Recommend High Performance Batteries for

- More Power
- Less Maintenance
- Longer Life

cc	Model	Year	High Performance Maintenance Free	Maintenance Free VRLA	YuMicron	Conventional	cc	Model	Year	High Performance Maintenance Free	Maintenance Free VRLA	YuMicron	Conventional
KYMCO							SUZUKI (continued)						
50	Mongoose 50	All	YTZ7S *	YTX5L-BS	-	-	300	LT-F300F KingQuad (CN, Opt)	'99-'02	-	-	Y50-N18A-A	-
90	Mongoose 90	All	YTZ7S *	YTX5L-BS	-	-	400	LT-A400 Eiger 2WD, F Eiger 4WD	'02-'07	YTX14H-BS *	YTX14-BS	-	-
150	MXU150	All	-	YTX9-BS	-	-		LT-F400 Eiger 2WD, F Eiger 4WD	'02-'07	YTX14H-BS *	YTX14-BS	-	-
250	Mongoose, MXU	All	-	YTX12-BS	-	-		LT-Z400 QuadSport	'03-'09	-	YTX9-BS	-	-
300	MXU300SD	All	-	YTX12-BS	-	-		LT-A400F King Quad	'09	YTX14H-BS *	YTX14-BS	-	-
POLARIS							YAMAHA						
50	Predator, Outlaw	'04-'09	YTZ7S *	YTX5L-BS	-	-	50	YFM50 Raptor	'04-'09	-	-	-	12N7D-3B
	Scrambler	'01-'02	-	YTX4L-BS	-	-	80	YFM80 Badger	'85-'01	-	-	-	12N7D-3B
	Scrambler	'03	YTZ7S *	YTX5L-BS	-	-		YFM80 Grizzly	'05-'08	-	-	-	12N7D-3B
90	Predator, Sportsman, Outlaw	'03-'09	YTZ7S *	YTX5L-BS	-	-		YFM80R Raptor	'02-'08	-	-	-	12N7D-3B
	Scrambler, Sportsman	'01-'02	-	YTX4L-BS	-	-	100	YFM100 Champ	'87-'91	-	-	-	12N7D-3B
200	Phoenix, Sawtooth	'05-'09	-	YTX12-BS	-	-	125	YFA-1 Breeze	'89-'04	-	-	-	-
250	All Models	'85-'05	YTX14AH-BS *	-	YB14A-A2	-		YFM125S, G	'04-'08	-	-	YB12C-A	-
300	Hawkeye, Sportsman 300	'06-'09	-	-	YB14A-B2	-	200	YFM200, DX Moto 4	'85-'89	YTX14AH-BS *	-	YB14A-A1	-
325	All Models	'87-'02	YTX14AH-BS *	-	B14A-A2	-		YTM200, E, ER Tri Moto	'83-'85	YTX14AH-BS *	-	YB14A-A1	-
330	Magnum, Trail	'03-'09	YTX14AH-BS	-	-	-	225	YFM225 Moto 4	'86-'88	YTX14AH-BS *	-	YB14A-A1	-
335	Sportsman	'98-'01	YTX14AH-BS *	-	YB14A-A2	-		YTM225DR, DX Tri-Moto	'83-'86	YTX14AH-BS *	-	YB14A-A1	-
400	All Models	'94-'08	YTX14AH-BS *	-	YB14A-A2	-	230	YFU-1/T Pro-Hauler	'89	YTX14AH-BS *	-	YB14A-A1	-
	Sportsman	'09	YTX14AH-BS *	-	-	-	250	YFB250, F Timber Wolf	'92-'00	-	-	YB12C-A	-
425	All Models	'95-'02	YTX14AH-BS *	-	YB14A-A2	-		YFM250 Bear Tracker	'99-'04	YTX14AH-BS *	-	YB14A-A2	-
450	Diesel, 445 Litre (primary)	'99-'03	-	YIX30L	YB30L-B	-		YFM250 Moto 4	'89-'91	YTX14AH-BS *	-	YB14A-A1	-
	Diesel, 445 Litre (secondary)	'99-'03	YTX14AH-BS *	-	YB14A-A2	-		YFM250B Big Bear	'07-'08	YTX14AH-BS *	-	YB14A-A2	-
	Outlaw 450	'07-'09	-	YTX9-BS	-	-		YFM250B Bruin	'05-'06	YTX14AH-BS *	-	YB14A-A2	-
500	All Models (Excl. Predator, Sportsman)	'99-'09	YTX14AH-BS *	-	YB14A-A2	-		YFM250R Raptor	'08-'09	YTZ7S	-	-	-
	Predator, Outlaw	'03-'06	-	YTX9-BS	-	-		YFM350B Bruin	'04-'06	YTX14AH-BS	-	-	-
	Sportsman	'09	-	YIX30L	-	-		YFM350ER Moto 4	'87-'95	YTX14AH-BS *	-	YB14A-A1	-
525	Outlaw 525	'08-'09	-	YTX9-BS	-	-		YFM350F, U Big Bear	'87-'99	YTX14AH-BS *	-	YB14A-A1	-
600	Sportsman	'04-'05	-	YIX30L *	YB30L-B	-		YFM350FX Wolverine	'95-'05	-	-	YB12C-A	-
700	Sportsman, Military	'02-'08	-	YIX30L *	YB30L-B	-		YFM350FX Wolverine	'06-'08	YTX14AH-BS	-	-	-
	Sportsman	'09	-	YIX30L	-	-		YFM350G FG Grizzly	'07-'09	YTX14AH-BS	-	-	-
800	Sportsman	'05-'09	-	YIX30L	-	-		YFM350R Raptor	'04-'09	YTZ10S	-	-	-
QIANJIANG							SUZUKI						
100	ATV100	-	-	YTX4L-BS	-	-	50	LT-Z50 QuadSport	'06-'09	YTZ7S *	YTX5L-BS	-	-
50	ATV50	-	-	YTX4L-BS	-	-	80	LT80 QuadSport 80	'87-'06	YTZ7S *	YTX5L-BS	-	-
SUZUKI							SUZUKI						
50	LT-Z50 QuadSport	'06-'09	YTZ7S *	YTX5L-BS	-	-	90	LT-Z90 QuadSport	'07-'09	-	YTX7A-BS	-	-
80	LT80 QuadSport 80	'87-'06	YTZ7S *	YTX5L-BS	-	-	160	LT160 E QuadRunner	'89-'94	-	-	YB9A-A	-
90	LT-Z90 QuadSport	'07-'09	-	YTX7A-BS	-	-		LT160 E QuadRunner	'03-'04	-	-	YB9A-A	-
160	LT160 E QuadRunner	'89-'94	-	-	YB9A-A	-		LT-F160 QuadRunner	'91-'01	-	-	YB9A-A	-
	LT160 E QuadRunner	'03-'04	-	-	-	-		LT-F160 QuadRunner	'91-'01	-	-	-	-
230	LT230E QuadRunner	'87	Not available	-	-	-	230	LT230E QuadRunner	'87	-	-	-	-
	LT230E QuadRunner	'88-'93	-	YTX12-BS	-	-		LT230G QuadRunner	'88-'93	-	-	-	-
	LT230G QuadRunner	'85-'86	-	-	YB10A-A2	-		LT-F230 QuadRunner	'86-'87	-	-	YB10A-A2	-
	LT-F230 QuadRunner	'86-'87	-	-	Y50-N18A-A	-		LT250EF QuadRunner	'85-'86	-	-	Y50-N18A-A	-
250	LT250EF QuadRunner	'85-'86	-	-	YB14A-A2	-		LT-4WD QuadRunner	'87-'99	YTX14AH-BS *	-	YB14A-A2	-
	LT-4WD QuadRunner	'87-'99	-	-	Y50-N18A-A	-		LT-4WD QuadRunner (Opt)	'87-'99	-	-	Y50-N18A-A	-
	LT-F250 QuadRunner	'88-'01	YTX14AH-BS *	-	Y50-N18A-A	-		LT-F250 QuadRunner	'88-'01	YTX14AH-BS *	-	Y50-N18A-A	-
	LT-F250 QuadRunner (Opt)	'88-'01	-	-	Y50-N18A-A	-		LT-F250 QuadRunner (Opt)	'88-'01	-	-	Y50-N18A-A	-
	LT-F250, F Ozark	'02-'09	-	YTX12-BS	-	-		LT-F250F QuadRunner	'99-'02	YTX14AH-BS *	-	YB14A-A2	-
	LT-F250F QuadRunner	'99-'02	-	-	Y50-N18A-A	-		LT-F250F QuadRunner (CN, Opt)	'99-'02	-	-	Y50-N18A-A	-
	LT-Z250 QuadSport	'04-'09	-	YTX9-BS	-	-		LT-Z250 QuadSport	'04-'09	-	-	-	-
280	LT-F4WDX KingQuad	'91-'99	YTX14AH-BS *	-	YB14A-A2	-		LT-F4WDX KingQuad	'91-'99	YTX14AH-BS *	-	YB14A-A2	-
	LT-F4WDX KingQuad (CN, Opt)	'91-'99	-	-	Y50-N18A-A	-		LT-F4WDX KingQuad (CN, Opt)	'91-'99	-	-	Y50-N18A-A	-
300	LT-F4WDX KingQuad	'99-'02	YTX14AH-BS *	-	YB14A-A2	-		LT-F4WDX KingQuad (Opt)	'99-'02	-	-	Y50-N18A-A	-
	LT-F4WDX KingQuad (Opt)	'99-'02	-	-	Y50-N18A-A	-		LT300E QuadRunner 300E	'87-'89	YTX14AH-BS *	-	YB14A-A2	-
	LT300E QuadRunner 300E	'87-'89	-	-	YB14A-A2	-		LT-F300F KingQuad	'99-'02	YTX14AH-BS *	-	YB14A-A2	-
	LT-F300F KingQuad	'99-'02	-	-	YB14A-A2	-							



PERSONAWATERCRAFT

cc	Model	Year	High Performance Maintenance Free	Maintenance Free VRLA	YuMicron	Conventional	cc	Model	Year	High Performance Maintenance Free	Maintenance Free VRLA	YuMicron	Conventional
AQUA-JETCO.							ARCTIC CA						
430	Aqua-Jet SX1	'91	-	-	YB16-B	-	640	Tiger Shark	'97-'99	YTX14AHL-BS *	-	YB14L-A2	-
432	Aqua-Jet Sx1	'89-'90	-	-	YB16-B	-	770	Tiger Shark	'97-'99	YTX14AHL-BS *	-	YB14L-A2	-

* See Battery Upgrade Cross Reference Chart on page 9.

**Recommend
High Performance
Batteries**

for
 • More Power
 • Less Maintenance
 • Longer Life

PERSONA WATERCRAFT



cc	Model	Year	High Performance Maintenance Free	Maintenance Free VRLA	YuMicron	Conventional	cc	Model	Year	High Performance Maintenance Free	Maintenance Free VRLA	YuMicron	Conventional
BRP(SEADOO)							KAWASAKI (JET SKI) (continued)						
1500	GTI, GTX, RXP, RXT	'09	-	-	YB30CL-B	-	800	JS800 SX-R	'03-'09	YTX20HL-BS *	YTX20L-BS	-	-
1500	GTX 4-Tec, RXP	'03-'07	-	-	YB30CL-B	-	900	JH900 ZXi	'95-'97	YTX20HL-BS *	YTX20L-BS	-	-
	All Models	'88-'93	YTX20HL-BS *	YTX20L-BS *	YB16L-B	-		JT900 STS, STX	'97-'05	YTX20HL-BS *	YTX20L-BS	-	-
	All Other Models	'94-'07	YTX20HL-BS-PW *	-	YB16CL-B	-	1100	JH1100 ZXi	'96-'03	YTX20HL-BS *	YTX20L-BS	-	-
780	3D	'07	YTX20HL-BS-PW *	-	YB16CL-B	-		JH1100-B Ultra 130	'01-'04	YTX20HL-BS *	YTX20L-BS	-	-
HONDA							POLARIS						
1235	AquaTrax F/R-12, F/R-12X	02-'09	YTX20HL-BS *	YTX20L-BS	-	-	All	All Models	All	YTX20HL-BS-PW *	-	YB16CL-B	-
1470	AquaTrax F-15, F-15X	03-'09	YTX20HL-BS *	YTX20L-BS	-	-	S.O.S. MARINE MFG						
KAWASAKI (JETSKI)							All All Models All YTX20H-BS * YTX20-BS * YB16-B-CX * YB16-B						
300	JS300 TS, SX	'86-'91	YTX20HL-BS-PW *	-	YB16CL-B	-	ULTRANAUTICS						
400	JS400	'76	YTX20HL-BS *	YTX20L-BS *	YB16L-B	-	800	All Models	'87-'92	-	-	53030	-
440	JS440	'87-'92	YTX20HL-BS-PW *	-	YB16CL-B	-		Wet Bike	'85-'86	-	-	-	YHD-12H
	JS440	'77-'86	YTX20HL-BS *	YTX20L-BS *	YB16L-B	-	1250	Jet Star1250 (Boat)	'88-'90	-	-	53030	-
550	JS550	'82-'85	YTX20HL-BS *	YTX20L-BS *	YB16L-B	-		Jet Star1250 (Boat)	'91	-	-	53030	-
	JS550, SX	'86-'95	YTX20HL-BS-PW *	-	YB16CL-B	-	WETJETINTERNATIONAL						
650	JF650 TS	'89-'96	YTX20HL-BS-PW *	-	YB16CL-B	-	All	All Models	All	YTX20H-BS *	YTX20-BS *	YB16-B-CX *	YB16-B
	JF650 X2	'86-'95	YTX20HL-BS-PW *	-	YB16CL-B	-	YAMAHA						
	JL650 SC	'91-'95	YTX20HL-BS-PW *	-	YB16CL-B	-	All	All Wave Runner Models	'87-'09	YTX20HL-BS-PW *	-	YB16CL-B	-
	JS650 SX	'87-'95	YTX20HL-BS-PW *	-	YB16CL-B	-	All All Models All YTX20HL-BS-PW * - YB16CL-B -						
750	JH750 B1-b3	'93-'95	YTX20HL-BS-PW *	-	YB16CL-B	-	All All Models All YTX20H-BS * YTX20-BS * YB16-B-CX * YB16-B						
	JH750 E1,F2, G1, G2	'95-'99	YTX20HL-BS *	YTX20L-BS	-	-	YAMAHA						
	JH750 SS,ST, Xi, XIR	'92-'99	YTX20HL-BS-PW *	-	YB16CL-B	-	All	All Models	All	YTX20HL-BS-PW *	-	YB16CL-B	-
	JH750 ST, Zxi	'95-'97	YTX20HL-BS *	YTX20L-BS	-	-	All All Models All YTX20H-BS * YTX20-BS * YB16-B-CX * YB16-B						
	JH750 SX,ZX	'92-'95	YTX20HL-BS-PW *	-	YB16CL-B	-	YAMAHA						
	JS750 SX, Zx	'92-'95	YTX20HL-BS-PW *	-	YB16CL-B	-	All	All Models	All	YTX20H-BS *	YTX20-BS *	YB16-B-CX *	YB16-B
	JS750 SXi, SXi Pro	'95-'02	YTX20HL-BS *	YTX20L-BS	-	-	YAMAHA						
	JT750 STS, STX	'96-'98	YTX20HL-BS *	YTX20L-BS	-	-	All	All Wave Runner Models	'87-'09	YTX20HL-BS-PW *	-	YB16CL-B	-

SNOWMOBILE



cc	Model	Year	High Performance Maintenance Free	Maintenance Free VRLA	YuMicron	Conventional	cc	Model	Year	High Performance Maintenance Free	Maintenance Free VRLA	YuMicron	Conventional
ARCTIC CA							ARTIC CAT (continued)						
Z1, T Z1		'09	YTX20H-BS	-	-	-	Jag Z	'93	YTX14AHL-BS *	-	YB14L-A2	-	-
T500, T570		'09	-	-	YB18-A	-	Jag, Jag Dix	'94-'99	YTX14AH-BS *	-	YB14-A2	-	-
4 Stroke Trail, Touring		'02-'03	YTX24HL-BS *	-	Y50-N18L-A-CX	-	Jag, Jag Dix	'85-'93	YTX14AHL-BS *	-	YB14L-A2	-	-
Bearcat 340,440		'95-'00	YTX14AH-BS *	-	YB14-A2	-	Jaguar	'07	YTX20H-BS	-	-	-	-
Bearcat 570		'04-'09	YTX24HL-BS *	-	Y50-N18L-A-CX	-	King Cat 900	'04-'06	YTX24HL-BS *	-	Y50-N18L-A-CX	-	-
Bearcat WT Turbo		'06-'07	YTX24HL-BS	-	-	-	Lynx	'91-'93	YTX14AHL-BS *	-	YB14L-A2	-	-
Bearcat WT		'05-'07	YTX24HL-BS	-	-	-	M 5	'05-'06	YTX20H-BS	-	-	-	-
Bearcat WT		'03-'04	YTX24HL-BS *	-	Y50-N18L-A	-	M 6	'05-'07	YTX20H-BS	-	-	-	-
Cheetah		'95-'02	YTX20H-BS *	YTX20-BS *	YB18-A	-	M 7	'05-'06	YTX20H-BS	-	-	-	-
Cheetah		'91-'93	YTX14AHL-BS *	-	YB14L-A2	-	Mountain Cat	'01	YTX20H-BS *	YTX20-BS *	YB18-A	-	-
Cheetah		'86-'90	-	-	YB16L-B	-	Mountain Cat 500	'02	YTX20H-BS *	YTX20-BS *	YB18-A	-	-
Cougar		'95-'98	YTX20H-BS *	YTX20-BS *	YB18-A	-	Mountain Cat 570	'02-'04	YTX24HL-BS *	-	Y50-N18L-A-CX	-	-
Cougar		'91-'94	YTX14AHL-BS *	-	YB14L-A2	-	Mountain Cat 600	'02-'04	YTX20H-BS *	YTX20-BS *	YB18-A	-	-
Cougar		'85-'90	-	-	YB16L-B	-	Mountain Cat 800	'02-'04	YTX24HL-BS *	-	Y50-N18L-A-CX	-	-
Crossfire 500		'07	YTX20H-BS	-	-	-	Mountain Cat 900	'03-'04	YTX24HL-BS *	-	Y50-N18L-A-CX	-	-
Crossfire 600		'06-'07	YTX20H-BS	-	-	-	Mountain Cat 1000	'02	YTX20H-BS *	YTX20-BS *	YB18-A	-	-
Crossfire 700		'06	YTX20H-BS	-	-	-	Pantera	'99-'01	YTX20H-BS *	YTX20-BS *	YB18-A	-	-
Ei Tigre 5000		'87-'88	YTX14AHL-BS *	-	YB14L-A2	-	Pantera	'95-'98	YTX24HL-BS *	-	Y50-N18L-A-CX	-	-
EXT		'95-'97	-	-	-	12N7-4A	Pantera	'94	YTX20H-BS *	YTX20-BS *	YB18-A	-	-
EXT		'92-'94	YTX14AHL-BS *	-	YB14L-A2	-	Pantera	'86-'93	YTX14AHL-BS *	-	YB14L-A2	-	-
EXT		'89-'91	-	-	YB16L-B	-	Pantera	'80-'85	-	-	YB16L-B	-	-
EXT (Carb)		'95-'96	YTX20H-BS *	YTX20-BS *	YB18-A	-	Pantera 550, 600	'02-'05	YTX20H-BS *	YTX20-BS *	YB18-A	-	-
EXT (EFI)		'98	YTX20H-BS *	YTX20-BS *	YB18-A	-	Pantera 800	'02-'04	YTX24HL-BS *	-	Y50-N18L-A-CX	-	-
EXT (EFI)		'95-'97	-	-	-	12N7-4A	Panther	'94-'96	YTX14AH-BS *	-	YB14-A2	-	-
EXT 600		'97-'98	YTX20H-BS *	YTX20-BS *	YB18-A	-	Panther	'89-'93	YTX14AHL-BS *	-	YB14L-A2	-	-
EXT Dix (EFI)		'97-'98	YTX24HL-BS *	-	Y50-N18L-A-CX	-	Panther	'80-'88	-	-	YB16L-B	-	-
EXT Special		'91-'92	YTX14AHL-BS *	-	YB14L-A2	-	Panther 340	'97-'00	YTX14AH-BS *	-	YB14-A2	-	-
F6, F8, F1000		'07-'09	YTX20H-BS	-	-	-	Panther 370	'01-'07	YTX14AH-BS *	-	YB14-A2	-	-
F5		'07-'09	YTX20H-BS *	YTX20-BS *	YB18-A	-	Panther 440	'97-'03	YTX14AH-BS *	-	YB14-A2	-	-
Firecat		'03-'06	YTX24HL-BS *	-	Y50-N18L-A-CX	-	Panther 550	'97-'01	YTX20H-BS *	YTX20-BS *	YB18-A	-	-
Jag AFS		'89-'91	YTX14AHL-BS *	-	YB14L-A2	-	Panther 570	'02-'07	YTX24HL-BS *	-	Y50-N18L-A-CX	-	-
Jag AFS L/T		'89-'93	YB14L-A2	-	-	-	Panther 660	'06-'07	YTX24HL-BS *	-	Y50-N18L-A-CX	-	-
Jag Liquid		'96	YTX14AH-BS *	-	YB14-A2	-	Powder Extreme	'97-'98	YTX20H-BS *	YTX20-BS *	YB18-A	-	-
Jag Z		'94	YTX14AH-BS *	-	YB14-A2	-	Powder Special	'95-'97	YTX20H-BS *	YTX20-BS *	YB18-A	-	-
							Prowler	'94	-	-	YB7-A *	-	12N7-4A

* See Battery Upgrade Cross Reference Chart on page 9



SNOWMOBILE

**Recommend
High Performance
Batteries**

for

**• More Power
• Less Maintenance
• Longer Life**

cc	Model	Year	High Performance Maintenance Free	Maintenance Free VRLA	YuMicron	Conventional	cc	Model	Year	High Performance Maintenance Free	Maintenance Free VRLA	YuMicron	Conventional	
ARTIC CAT (continued)							POLARIS (continued)							
	Prowler	'90-'93	YTX14AH-BS *	-	YB14L-A2	-		All Other Model	'92-'05	YTX14AH-BS *	-	YB14A-A2	-	
	Prowler 2-Up	'95	YTX20H-BS *	YTX20-BS *	YB18-A	-		Indy, Indy Trail	84-'91	YTX24HL-BS *	-	Y50-N18L-A-CX *	Y50-N18L-A	
	Prowler Special	'91-'92	YTX20H-BS *	YTX20-BS *	YB18-A	-		Sprint (Electric Start)	'86-'90	-	-	Y60-N24-A	-	
	Puma	'94-'96	YTX14AH-BS *	-	YB14-A2	-	600	IQ Touring	'09	YTX14AH-BS	-	-	-	
	Sabercat 500	'04-'06	YTX20H-BS *	YTX20-BS *	YB18-A	-	750	Wide Track	'89-'09	YTX24HL-BS *	-	Y50-N18L-A-CX *	Y50-N18L-A	
	Sabercat 600, 700	'04-'06	YTX24HL-BS *	-	Y50-N18L-A	-		FS/FST	'06-'09	YTX20HL-BS *	YTX20L-BS	-	-	
	T660 Touring	'04-'06	YTX24HL-BS *	-	Y50-N18L-A	-		Turbo Switchback, Turbo Dragon	'06-'09	YTX20HL-BS *	YTX20L-BS	-	-	
	T660 Turbo	'04-'07	YTX24HL-BS	-	-	-	YAMAHA							
	T660 Turbo Touring	'04-'07	YTX24HL-BS	-	-	-	80	SV80E Sno-Scoot	'88-'90	-	-	YB7L-B *	12N7-3B	
	Thundercat	'97-'02	YTX20H-BS *	YTX20-BS *	YB18-A	-	125	SV125E Sno-Sport	'90-'91	YTX14AH-BS *	-	YB14L-A2 *	12N14-3A	
	Wildcat (EFI)	'95-'96	-	-	YB7-A *	12N7-4A	300	CF300 Inviter	'86-'90	-	-	YB16AL-A2	-	
	Wildcat (EFI)	'93	-	-	YB16L-B	-	340	CS340 Ovation Deluxe/LE	'89-'98	YTX14AH-BS *	-	YB14L-A2 *	12N14-3A	
	Wildcat MC	'94	-	-	YB7-A *	12N7-4A		EC340 Excel III	'81-'88	YTX14AH-BS *	-	YB14L-A2 *	12N14-3A	
	Wildcat Touring	'95-'96	-	-	YB7-A *	12N7-4A		ET340E Enticer	'79	YTX24HL-BS *	-	Y50-N18L-A-CX *	Y50-N18L-A	
	Z	'98-'01	YTX14AH-BS *	-	YB14-A2	-	480	PZ480E Phazer Deluxe	'84-'89	YTX14AH-BS *	-	YB14L-A2 *	12N14-3A	
	Z 370, 440	'02-'07	YTX14AH-BS *	-	YB14-A2	-		PZ480E Phazer Deluxe	'90-'98	YTX14AH-BS *	-	YB14L-A2 *	12N14-3A	
	Z 570	'02-'08	YTX24HL-BS *	-	Y50-N18L-A-CX	-		VT480 Venture GT	'92-'93	YTX14AH-BS *	-	YB14L-A2 *	12N14-3A	
	ZL 500	'02	YTX20H-BS *	YTX20-BS *	YB18-A	-		VT480 Venture GT	'91-'97	YTX14AH-BS *	-	YB14L-A2 *	12N14-3A	
	ZL 550, 600	'02-'03	YTX20H-BS *	YTX20-BS *	YB18-A	-		VT480TR Venture TR Electric	'98	YTX14AH-BS *	-	YB14L-A2 *	12N14-3A	
	ZL 800	'02-'03	YTX24HL-BS *	-	Y50-N18L-A-CX	-	499	Phazer	'09	YTX14H-BS *	YTX14-BS	-	-	
	ZR (EFI)	'95-'96	-	-	YB7-A *	12N7-4A		Venture Lite	'09	YTX14H-BS *	YTX14-BS	-	-	
	ZR 500, 600	'01-'02	YTX20H-BS *	YTX20-BS *	YB18-A	-	500	PZ500DX Phazer 500 Deluxe	'01	-	-	YB16AL-A2	-	
	ZR 800	'02-'03	YTX24HL-BS *	-	Y50-N18L-A-CX	-		VT500 Venture 500	'97-'01	-	-	YB16AL-A2	-	
	ZR 900	'03-'06	YTX24HL-BS *	-	Y50-N18L-A-CX	-		VT500 Venture 500 XL	'99-'00	-	-	YB16AL-A2	-	
	ZRT	'97-'02	YTX20H-BS *	YTX20-BS *	YB18-A	-		VX500E Vmax	'94-'01	-	-	YB16AL-A2	-	
BRP- SKI-DOO							540	EC540 Excel	'79-'80	YTX24HL-BS *	-	Y50-N18L-A-CX *	Y50-N18L-A	
	All 4-stroke	'03	YTX24HL-BS	-	-	-		VK540E, II, III	'89-'03	-	-	YB16AL-A2	-	
	All Models	(Thru)'98	YTX24HL-BS *	-	Y50-N18L-A-CX *	Y50-N18L-A		XL540 XLV	'85-'90	-	-	YB16AL-A2	-	
	CK3 Types	'99-'03	YTX24HL-BS *	-	Y50-N18L-A-CX *	Y50-N18L-A	570	EX570E Exciter	'88-'90	-	-	YB16AL-A2	-	
	Elite	'04-'06	-	YIX30L	-	-		EX570E Exciter II LE	'91-'93	-	-	YB16AL-A2	-	
	ZX Types	'99-'01	-	YTX15L-BS	-	-	600	VT600 Venture 600	'97-'98	-	-	YB16AL-A2	-	
	ZX Types	'02-'03	YTX20HL-BS *	YTX20L-BS	-	-		VT600 Venture 600	'99-'06	YTX24HL-BS *	-	Y50-N18L-A-CX *	Y50-N18L-A	
300	Skandic	'09	YTX20HL F/A *	YTX20L F/A *	-	-		VX600DX Vmax 600 Deluxe	'99-'01	YTX24HL-BS *	-	Y50-N18L-A-CX *	Y50-N18L-A	
550	Expedition, Freestyle, Skandic	'09	YTX20HL F/A *	YTX20L F/A *	-	-		VX600E/DX Vmax 600 LE/DX	'94-'96	-	-	YB16AL-A2	-	
600	GSX, GTX, MX Z	'09	YTX20HL F/A *	YTX20L F/A *	-	-		VX600ER Vmax 600 ER	'02-'03	YTX24HL-BS *	-	Y50-N18L-A-CX *	Y50-N18L-A	
600	Expedition, Skandic, Summit	'09	YTX20HL F/A *	YTX20L F/A *	-	-		VX600XTC Vmax 600 XTC	'97-'98	-	-	YB16AL-A2	-	
800	GSX, GTX	'09	YTX20HL F/A *	YTX20L F/A *	-	-	700	SVX700ER Viper ER	'02-'05	YTX24HL-BS *	-	Y50-N18L-A-CX *	Y50-N18L-A	
800	Expedition, Legend, Skandic	'09	YTX24HL F/A *	YTX20L F/A *	-	-		VT700 Venture 700	'98-'04	YTX24HL-BS *	-	Y50-N18L-A-CX *	Y50-N18L-A	
800	GSX, MX Z, Summit	'09	YTX20HL F/A *	YTX20L F/A *	-	-		VX700DX Vmax 700 Deluxe	'99-'00	YTX24HL-BS *	-	Y50-N18L-A-CX *	Y50-N18L-A	
KAWASAKI								VX700ER Vmax 700 ER	'01-'02	YTX24HL-BS *	-	Y50-N18L-A-CX *	Y50-N18L-A	
	All Models	All	YTX24HL-BS *	-	Y50-N18L-A-CX *	Y50-N18L-A		VX700XTC Vmax 700 XTC Deluxe	'98	YTX24HL-BS *	-	Y50-N18L-A-CX *	Y50-N18L-A	
POLARIS							973	Vector	'09	YTX20HL-BS *	YTX20L-BS	-	-	-
	All EFI (RXL, 500 EFI)	'93-'97	-	-	YB9A-A	-		Viking	'09	YTX20HL-BS *	YTX20L-BS	-	-	
	All Electric Start Kits	'85-'93	YTX24HL-BS *	-	Y50-N18L-A-CX *	Y50-N18L-A		Apex	'06-'09	YTX14H-BS *	YTX14-BS	-	-	
	All Electric Start Kits	'94-'05	YTX14AH-BS *	-	YB14A-A2	-	1000	RS1000S, GT, RS		YTX20HL-BS *	YTX20L-BS	-	-	
								RX1000R RX (All Models)	'03-'05	YTX20HL-BS *	YTX20L-BS	-	-	
							1049	Nitro	'09	YTX20HL-BS *	YTX20L-BS	-	-	
								Venture	'09	YTX20HL-BS *	YTX20L-BS	-	-	



EUROPEAN & OTHER MOTORCYCLE

cc	Model	Year	Battery Type	cc	Model	Year	Battery Type	cc	Model	Year	Battery Type
APRILIA				APRILIA (continued)				APRILIA (continued)			
1000	ETV Caponord	'02-'03	YTX14-BS *	750	Shiver	'09	YTX14-BS *	50	Scarabeo 50	'00-'03	YB4L-B
	RST Futura	'01-'04	YTX12-BS	650	Pegaso	'00	YB12AL-A		Mojito	'04-'05	YB4L-B
	RSV 1000 Mille SP	'99	YTX12-BS	500	Scarabeo	'04-'05	YTX14AH-BS *		Rally	'04-'05	YB4L-B
	RSV 1000 Factory	'04-'05	YTX12-BS	250	RS250	'03-'05	YTX14AH-BS *	ATK			
	RSV 1000 Mille R	'01-'05	YTX12-BS	200	Atlantic	'00-'04	YB4L-B		All Electric Start Models	'91-'95	YTX9-BS
	RSV 1000 Mille	'01-'09	YTX12-BS	150	Scarabeo	'00-'04	YB12AL-A		All Electric Start Models	'96-'01	YTX7L-BS
	RSV 1000 Mille	'00	YTX12-BS		Mojito	'04-'05	YTX7L-BS				
	Tuono	'03-'05	YTX12-BS	50	RS50	'00-'05	YB4L-B				
	SL Falco	'01-'03	YTX14-BS *	50	SR50	'00-'01	YB4L-B				
850	MANA850	'09	YTX14-BS *		SR50 Ditech	'01-'05	YTX5L-BS *				

* See Battery Upgrade Cross Reference Chart on page 9.

FA Must use Factory Activated battery

EUROPEAN & OTHER MOTORCYCLE

cc	Model	Year	Battery Type	cc	Model	Year	Battery Type	cc	Model	Year	Battery Type
BENELLI				BSA				DUCATI (continued)			
900	900 (6 Cilindri)		53030	250, 350, 400, 441, 500 (12V)			YB7-A *	650	Alazzurra, Indiana, Pantah		YTX14AHL-BS *
650	650 Tornado U.T.		YB12A-A *	600, 650, 750 (12V)			YB7-A *	600	Pantah		YTX14AHL-BS *
250	250 (4 Cilindri)		YB12A-A	250, 350, 650 (6V)			B39-6		TL		YTX14AHL-BS *
	250-2C		6N11A-1B	500 Gold Star			B38-6A	500	GTL, GTV		Y50-N18L-A *
125	125 Cross		6N11A-1B	500 Thunderbolt			YB9L-B *	500	Pantah		YTX14AHL-BS *
	125 Custom Guzzi		12N5.5-4A	Spitfire HK35, Starfire B25			YB9L-B *	500	Sport		Y50-N18L-A *
	125 Guzzi		12N5.5-4A								
	125 Jarno (c/avv.)		YB9-B *								
	125 Scooter Benelli		YB9L-B *								
	125-2 CSE		6N11A-1B								
	125CS		YB9-B *								
	125T Sport		6N11A-1B								
50	Devil 50 (c/avv.)		YB4L-B								
	KBX 50 Race		YB4L-B								
	Scooty LX/DLX		YB4L-B								
BIMOTA				CAGIVA				GAS GAS			
1100	SB6, SB7	'95-'97	YTX7L-BS (x2)	900	Elefant E900		YB16B-A1	370	Pampera	'97	YTX4L-BS
	SB6R	'97-'99	YTX12-BS	750	Elefant	'94-'97	YB16-B *	320	Pampera	'98-'01	YTX4L-BS
1000	YB8/YB10	'92-'95	YTX14AHL-BS *		Elefant Bifaro	'89	YTX14AHL-BS *	250	Pampera	'96-'01	YTX4L-BS
	YB11	'96-'99	YTX12-BS	500	T4 E Elefant	'88-	YTX14AHL-BS *				
996	SB8R, SB8RS	'98-'00	YTX12-BS	350	Elefant 2 Cyl.	'86-	YTX14AHL-BS *				
900	DB2	'93-'95	YB14-A2 *		T4 E Elefant, W12	'87-	YTX14AHL-BS *				
	DB2 Final Edition	'97	YB14-A2 *	125	T4R	'87-	YB3L-A				
	DB3 Mantra	'97-'99	YTX7L-BS (x2)		Crouser	'87-'88	YB9-B	600	Nordwest	'93	YTX14AHL-BS *
	DB4	'98-'00	Not available		Freccia C9, /C10R, /C12R	'87-'90	YB9-B		RC 600C	'93	YTX14AHL-BS *
	Tesi	'91-'95	YB14-A2 *		Mito	'90-'97	YB9-B		Top Rally, XRT		YTX14AHL-BS *
					N 90	'97	YB9-B	500	Dakota Kick-Start		12N5.5-3B
					Roadster	'94-'97	YB9-B	350	Dakota E-Starter		YB10L-A2
					Supercity	'91-'97	YB9-B		Dakota Kick-Start		12N5.5-3B
					City, Lucky, Explorer	'94-'97	YTX4L-BS		Dakota E-Starter		YB10L-A2
					K3, W4	-'98	YB4L-B		ER Kick-Start		12N5.5-3B
									ER E-Starter		YTX14AHL-BS *
									Arizona Rally		YB10L-B
									RV NGR Kick-Start		12N5.5-3B
									RV NGR E-Starter		YB10L-B
									Arizona		12N5.5-3B
									Arizona		YB9-B
									Fast Bike		12N5.5-3B
									Fast Bike		YB9-B
									RTX, RV, RX Kick-Start		12N5.5-3B
									RTX, RV, RX E-Starter		YB9-B
									T4		12N5.5-3B
									Motocarro		B38-6A
									Apache Kick-Start		12N5.5-3B
									Apache E-Starter		YB9-B
									Arizona Kick-Start		12N5.5-3B
									Arizona E-Starter		YB9-B
									Crona Kick-Start		12N5.5-3B
									Crona E-Starter		YB9-B
									CX Kick-Start		12N5.5-3B
									CX E-Starter		YB9-B
									Fast Bike Kick-Start		12N5.5-3B
									Fast Bike E-Starter		YB9-B
									Freestyle Kick-Start		12N5.5-3B
									Freestyle E-Starter		YB9-B
									GFR Kick-Start		12N5.5-3B
									GFR E-Starter		YB9-B
									KK, KZ Kick-Start		12N5.5-3B
									KK, KZ E-Starter		YB9-B
									MX1, MXR Kick-Start		12N5.5-3B
									MX1, MXR E-Starter		YB9-B
									Nebraska Kick-Start		12N5.5-3B
									Nebraska E-Starter		YB9-B
									R1, R1S Kick-Start		12N5.5-3B
									R1, R1S E-Starter		YB9-B
									RC Rally		YB10L-B
									RTX, RV, RX Kick-Start		12N5.5-3B
									RTX, RV, RX E-Starter		YB9-B
									SPO1, SPO2 Kick-Start		12N5.5-3B
									SPO1, SPO2 E-Starter		YB9-B
									TOP Rally Kick-Start		12N5.5-3B
									TOP Rally E-Starter		YB9-B
									Typhoon		YB7-A
									XR1, XR2 Kick-Start		12N5.5-3B
									XR1, XR2 E-Starter		YB9-B
									Bullit, Easy Moving, Runner	-'97	YB4L-B
									Eaglet	'95-'97	YB4L-B
									GSA E-Starter		YB4L-B
									Runner	-'97	YB4L-B
									Sioux E-Starter		YB4L-B
									Stalker, Storm, Top Rally		YB4L-B
									Typhoon	-'97	YB4L-B
BMW				CCM				GILERA			
1200	K1200R, S	'05-'09	YTX14-BS *	600	All Electric Start Models	'96-'01	YTX9-BS	200	Arizona		YB9-B
	R1200GS, S, R	'05-'09	YTX14-BS *						Arizona		12N5.5-3B
	K1200LT, GT	'05-'09	51913						Fast Bike		YB9-B
	K1200RT	'05-'09	51913						Fast Bike		12N5.5-3B
	K1200LT, GT, RS, S	'99-'05	51913						RTX, RV, RX Kick-Start		YB9-B
	K1200RS	'97-'05	51913						RTX, RV, RX E-Starter		12N5.5-3B
	R1200C	'98-'05	51913						T4		B38-6A
1150	R1150GS, R	'00-'05	51913						Motocarro		12N5.5-3B
1100	K1100LT/RS	'90-'95	51913						Apache Kick-Start		YB9-B
	R1100GS	'94-'00	51913						Apache E-Starter		12N5.5-3B
	R1100R	'94-'00	51913						Arizona Kick-Start		YB9-B
	R1100RS, RT	'93-'00	51913						Arizona E-Starter		12N5.5-3B
	R1100S	'99-'00	51913						Crona Kick-Start		YB9-B
1000	All "K" Models	'83-'93	53030						Crona E-Starter		12N5.5-3B
	R100/7	'76-'84	53030						CX Kick-Start		YB9-B
	R100GS, PD, R, RS, RT	'87-'95	53030						CX E-Starter		12N5.5-3B
	R100CS	'76-'84	53030						Fast Bike Kick-Start		YB9-B
900	R90/6, R90S	'69-'76	53030						Fast Bike E-Starter		12N5.5-3B
850	R850R	'95-'97	51913						Freestyle Kick-Start		YB9-B
800	F800ST, GS	'09	YTX14-BS *						Freestyle E-Starter		12N5.5-3B
	R80, R80RT	'84-'95	53030						GFR Kick-Start		YB9-B
	R80GS, R80ST	'80-'96	51814						GFR E-Starter		12N5.5-3B
	R80/7, R80RT	'78-'84	53030						KK, KZ Kick-Start		YB9-B
750	K75, RT	'85-'95	53030						KK, KZ E-Starter		12N5.5-3B
	K75C, S	'85-'95	51814						MX1, MXR Kick-Start		YB9-B
	R75/5	'70-'73	51814						MX1, MXR E-Starter		12N5.5-3B
	R75/7	'76-'84	53030						Nebraska Kick-Start		YB9-B
	R75/6	'69-'76	53030						Nebraska E-Starter		12N5.5-3B
700	R69 - R69S	'55-'69	B38-6A						R1, R1S Kick-Start		YB9-B
650	F650GS	'09	YTX14-BS *						R1, R1S E-Starter		YB9-B
	F650	'93-'00	YB12AL-A						RC Rally		YB10L-B
	R65	'84-'95	53030						RTX, RV, RX Kick-Start		12N5.5-3B
	R65LS	'78-'84	51814						RTX, RV, RX E-Starter		YB9-B
600	R60, R60/2 Twin Cylinders	'55-'69	B38-6A						SPO1, SPO2 Kick-Start		12N5.5-3B
	R60/5	'70-'73	51814						SPO1, SPO2 E-Starter		YB9-B
	R60/6, R60/7	'69-'84	53030						TOP Rally Kick-Start		12N5.5-3B
500	R50/2 Twin Cylinders	'55-'69	B38-6A						TOP Rally E-Starter		YB9-B
	R50/5	'70-'73	51814						Typhoon		YB7-A
	R50/S Twin Cylinders	'55-'69	B38-6A						XR1, XR2 Kick-Start		12N5.5-3B
260	R26, R27 Single Cylinder	'55-'69	6N11A-1B						XR1, XR2 E-Starter		YB9-B
	R 26		B39-6						Bullit, Easy Moving, Runner	-'97	YB4L-B
									Eaglet	'95-'97	YB4L-B
									GSA E-Starter		YB4L-B
									Runner	-'97	YB4L-B
									Sioux E-Starter		YB4L-B
									Stalker, Storm, Top Rally		YB4L-B
									Typhoon	-'97	YB4L-B



EUROPEAN & OTHER MOTORCYCLE

cc	Model	Year	Battery Type	cc	Model	Year	Battery Type	cc	Model	Year	Battery Type		
HUSABERG				MOTO GUZZI (continued)				PIAGGIO (VESPA) (continued)					
	All Electric Start Models	'01-'02	YTX5L-BS *	1000	Daytona		53030	Vespa 50 Elestart			6N11A-1B (x 2 pcs.)		
	All Electric Start Models	'97-'00	YTX9-BS		Le Mans		53030	Vespa 125 Sprint			B39-6		
HUSQVARNA					Mille		53030	Vespa 150 GL			B39-6		
580	TE610E, SM610S	'00-'01	YTX14-BS *	1000NT	Quota		53030	Vespa PK 50 FL/FL2 (c/a.v.)			YB7-A		
450	TE450/TC450		YTZ7S	V10 Centauro Sport, GT		'99-END	YTX15L FA	Zip - Zip (Fast Rider)			YB4L-B		
400	TE410E	'00-'01	YTX14-BS *	850	Le Man		53030	PUCH					
HYOSUNG					T3, T4, T5		53030	Cobra 80				B39-6	
650	GT650, R, S	'09	YTX14-BS *	750	Breva	'04-'09	YTX14AHL-BS *	Cobra GTL, Daytona N50, Monza				B39-6	
	GV650, SE	'09	YT14B-BS		Nevada		YB18L-A *	Lido SL50, Lido Vario				YB4L-B	
250	GT250, R	'09	YTX14-BS *		NTX		YB18L-A *	Monza GP, Monza GX, Monza X				B39-6	
	GV250	'09	YTX9-BS		Strada		YB18L-A *	ROYALENFIELD					
KTM					V7		53030	500 All Kick-start Models				'95-'99	YB7-A *
1090	RC8	'03-	YTZ14S	650	V75		YB18L-A *	All Kick-start Models				'00-'03	YB5L-B *
990	Super Duke	'03-'09	YTZ14S		NTX		YB18L-A *	All Electric Start Models				'00-'03	YTX14AHL-BS *
	Supermoto	'09	YTZ14S	500	V65 Florida		YB18L-A *	All Kick-start Models				'95-'99	YB7-A *
950	Superenduro	'09	YTZ14S	500	V65		53030	All Kick-start Models				'00-'03	YB5L-B *
	Supermoto	'09	YTZ14S		V65 Florida		YB18L-A *	All Electric Start Models				'00-'03	YTX14AHL-BS *
	Adventure	'03-'09	YTZ14S		Falcone		B38-6A	All Kick-start Models				'95-'99	YB7-A *
690	Duke	'09	YTZ10S		Falcone u.t.		YB18L-A *	All Kick-start Models				'00-'03	YB5L-B *
	Supermoto	'09	YTZ10S		V50		53030	All Electric Start Models				'00-'03	YTX14AHL-BS *
640	Adventurer, Duke, RXC LC4 Super Moto	'99-'02	YTX9-BS	MuZ				TRIUMPH					
	Duke II, LC4, Adventure	'03-'08	YTZ10S	660	Skorpion	'95-'01	YB9L-A2	2300 Rocket III				'03-'09	YTX20L-BS *
625	SMC, SXC	'03-'09	YTZ10S	125	All Models	All Years	YB9L-A2	1200 Trophy				'00-'04	YTX14-BS *
620	Adventure, Duke, LC4	'96-'98	YTX9-BS	MVAGUSTA				All Other Models				'93-'99	YTX14AHL-BS *
530	EXC, Racing	'03-'05	YTZ5S	1000	F4	'05-'08	YTZ10S	1050 Sprint ST, Speed Triple				'05-'09	YTX12-BS
	EXC, Racing	'05-'09	YTX5L-BS *	910	Brutale	'06-'09	YTZ10S	Speed Triple				'05-'09	YTX12-BS
	XC-W	'09-'02	YTX5L-BS *	750	F4, Brutale	'00-'08	YTZ10S	Tiger				'07-'09	YTX12B-BS
520	E/XC, M/XC Racing 4-Stroke	'00-'02	YTX4L-BS	NORTON				1000 Daytona				'92-'93	YTX14AHL-BS *
	E/XC, M/XC Racing 4-Stroke (Opt)	'00-'02	YTX5L-BS	850	Commando, Commando (75)		YTX14AHL-BS *	955 Daytona 955i, Speed Triple,					
450	EXC Racing	'03-'09	YTZ5S	750	Ranger Commando		YB9-B *	Sprint ST				'99-'04	YTX14-BS *
	EXC Racing	'05-'09	YTX5L-BS *	350	Navigator		6N11A-1B	Sprint RS				'00-'04	YTX14-BS *
	SX-F, XC-F, XC-W	'09	YTX5L-BS *	PIAGGIO (VESPA)				Tiger				'02-'06	YTX14-BS *
400	EXC Racing	'05-'09	YTX4L-BS *	APE CAR, MP, MPR, P602			53030	All Other Models				'96-'97	YTX14AHL-BS *
	EXC Racing	'03-'05	YTZ5S	Ape 50 FL		'93	YB9-B	900 Scrambler, Bonneville				'06-'07	6N11A-1B
	XC-W	'09	YTX9-BS	Boxer, Bravo, Ciao			B39-6	T90					
	E/XC Racing 4-Stroke	'00-'02	YTX4L-BS *	Cosa 2			YB7-A	Tiger				'99-'01	YTX14-BS
	E/XC Racing 4-Stroke (Opt)	'00-'02	YTX5L-BS	Cosa CLX 125 (c/avv.)			YB7-A	Thruxton				'03-'07	YTX12-BS
	LC4 E/XC	'96-'98	YTX9-BS	Cosa CLX 150 (c/avv.)			YB7-A	Thunderbird				'02-'03	YTX14AHL-BS *
	RXC LC4	'96-'01	YTX9-BS	Cosa CLX 200 (c/avv.)			YB7-A	All Other Models				'91-'01	YTX14AHL-BS *
250	EXC, Racing	'05-'09	YTX5L-BS *	Free			YB4L-B	865 America				'09	YTX12-BS
	EXC, Racing	'03-'05	YTZ5S	Hexagon 125/150			YB9-B	Bonneville T100, SE				'09	YTX12-BS
	EXF	'05-'09	YTX5L-BS *	NRG 50			YB4L-B	Scrambler				'09	YTX12-BS
MOTO GUZZI				P125ETES, P125TS			YB7-A *	Speedmaster				'09	YTX12-BS
1200	Norge	'09	YTX20CH-BS	P200E (c/avv.)			YB9-B	800 Bonneville				'01-'05	YTX12-BS
	Sport, ABS	'09	YTX20CH-BS	PK50, PK50-C.A., PK50N, PK50XL			YB7-A *	Speedmaster				'03-'05	YTX12-BS
1100	1100 California (CA only)	'03-'05	YTX15L-BS	PK80S-C.A.			YB7-A *	750 Bonneville, Tiger					
	1100 California, Special, Jackal,			PX125FL, PK125SS, PK125XL			YB7-A *	T150 Trident					
	Breva, Griso	'05-'09	YTX20CH-BS	PX125			YB9-B	All Other Models				'93-'97	YTX14AHL-BS *
	Stone, EV	'94-'05	53030	PX125+80E			12N5.5-3B	675 Daytona 675				'06-'09	YT7B-BS
	Quota 1100 ES	'99-'02	YTX15L FA	PX125+80E-AREC			12N5.5-3B	Street Triple				'09	YTX9-BS
	Sport 1100i	'97-'99	YTX15L-BS	PX125-80E-ARC			YB9-B	650 T120 Bonneville					
	V11 Bassa	'99-'00	53030	PX125T5			YB9-B	600 (12V)					
	V11 EV	'98-'99	53030	PX150E			YB9-B	6T, T20B					
	V11 Le Mans, Sport	'99-'05	YTX15L FA	PX150E-ARC			YB9-B	Daytona 600/650, Speed Four				'03-'05	YTX9-BS
1000	California III	'89-'93	53030	PX200-ARC			12N5.5-3B	TT600				'00-'03	YTX12-BS
	Convert		53030	PX200GS			YB9-B	500 (12V)					
				Quartz, Sacitto, Sfera 50, Sfera 80, Skipper 125/150			YB4L-B	5TA, TR5A/R					
								350 (6V)					
								350 (12V)					
								350 3TA, Twenty One					
								250 Tigress (6V)					
								Tigress (12V)					
								200 Tiger					
								173 Tigress					

* See Battery Upgrade Cross Reference Chart on page 9.

FA Must use Factory Adjusted batteries.

RIDING MOWER Battery Application



cc	Model	Year	Battery Type	cc	Model	Year	Battery Type	cc	Model	Year	Battery Type
ALLIS-CHALMERS				MONTGOMERY WARD				SEARS continued			
	405, 508		YB9-B *		99 & Under Series		YB9-B *		536.255110, 536.255112, 536.255113, 536.255212, 536.255220, 536.255221, 536.255230... 536.255232, 536.255240 536.255250, 536.657020, 536.657040 536.657060, 536.657080, 536.658080 536.963100, 917.250740, 917.255120, 917.255121, 917.259180, 917.259320		
ARIENS/GRAVELY CO.				MTD PRODUCTS				SIMPLICITY			
	901000 & 912000 Series 925000 & 927000 Series 1330, 1332, 8028, 8530		YB12A-A * YB14A-A2 *		300, 400, 500, 600 Series 385, 410, 412, 465, 485, 489, 497, 500 525, 526, 600, 698, 775, 795, 796 395, 760 700-800 Series		Y1X14AHL-BS * From 1981 Y50-N18L-A *	3008, 3008-3, 99075			
ATLAS TOOL & MFG. CO.				MURRAY OHIO MFG. CO.				SNAPPER			
	ER2600, ER2650, ER2680 ER3280		12N9-3A		2523, 3033, 3035 6-30502, 6-30502X4 6-30702, 6-30702X4, 7-30502		Y1X14AHL-BS *	All Walk Behind Mowers (Electric Start)			
BOLENS				NOMA				SWISHER			
	Husky 728, Husky 770, Husky 829		YB9-B *		321050... 321054, 328000... 328018, 360100, 360101		Y1X14AHL-BS *	18 Hp/32"			
CARTER BROTHERS				ROPER				WESTERN INT'L. (DYNAMARK)			
	EZ-502, EZ-502C, EZ-702 EZ-702C		YB12A-A *		96444, 96927, 96941, K522, K852 L722, L72256R K9224AR, K922PRA, K9324AR, K932PRA, L8000AT		YB9-B * Y1X14AHL-BS *	320800, 328000, 361000 361100, 361102... 361107 361113, 361114, 421101, 456301			
CASE INTERNATIONAL				SEARS				WHEEL HORSE/TORO			
	M80		YB12A-A *		502.256050, 502.256051, 502.256060...502.256063, 502.256070, 502.256071, 502.256080 502.256081, 502.256120... 502.256126, 502.256130... 502.256132, 502.256134, 502.256136A, 502.256138 917.255260, 917.255270... 917.255273 917.255330, 917.255340 502.256135, 502.256136, 502.256137 502.256140, 502.256141, 502.256142 131.96927, 131.969310, 131.96941, 131.96970, 536.250820... 536.250823 536.250870, 536.250920...536.250922,		Y1X14AHL-BS *	108-3, 108-5, 111-5 A85, A115			
GARDEN WAY/TROY BUILT				YARD MAN, INC.				WHITE OUTDOOR PRODUCTS			
	Pony (before 1996) Pony (after 1996)		YB12A-A * YB9-B *		13420, 3730 Beetle		12N9-3A Y1X14AHL-BS *	FST-16 GT-185, -205, -1000 LT-125, -155, -160, -165			
GENERAL POWER				JACOBSEN/HOMELITE/HUSTLER				YARD MAN, INC.			
	3-725-E7, 3-725-E8, 3-725-E9 WES725, WES725-FS		YB12A-A *		42642, 43020, 43032, 43037 43043, Javelin MK11, RE-8E		YB9-B *	13420, 3730 Beetle			
HUFFMAN MFG. CO. (Huffy)				LAWN BOY				YARD MAN, INC.			
	H-270, H-360		YB12A-A *		333, 335, 5802, 5803, 7258E 7259E, 7260E, 8227E, 8228E 8229E, 8229EA, 8233E		12N9-3A	13420, 3730 Beetle			

* See Battery Cross Reference Chart on page 9.

12 VOLT IMPORT SPECIALTY BATTERY SPECIFICATIONS

Yuasa Type	Old Reference Number (Discontinued)	Plate/Cell	Capacity AH (5 hr)	Capacity AH (20 hr)	Cranking Performance (Amps 0°F)	Reserve Capacity Minutes (80°F)	Overall Dimensions			Shipping Weight Dry (lbs.)	Volume of Acid (oz.)	Charging Current (Amp)	See Key	
							L (Inches)	W (Inches)	H (Inches)				Terminal	Layout
36B20L(S)	40B19L(S)NS40ZL(S)	9	28	35	275	52	7 3/4	5 1/16	8 15/16	17.9	84.6	3.5	A	2
46B24R	NS60	13	36	45	330	75	9 3/8	5 1/16	8 15/16	20.1	109.0	4.5	B	1
46B24L(S)	NX60L(S)	13	36	45	330	75	9 3/8	5 1/16	8 15/16	20.1	109.5	4.5	A	2
36B20L	40B19L/NS40ZL	9	28	35	275	52	7 3/4	5 1/16	8 15/16	17.9	91.7	3.5	B	2
55B24L(S)	NX100S6L(S)	13	36	45	410	70	9 3/8	5 1/16	8 15/16	21.3	109.3	4.5	A	2
115F51	N120	21	96	120	638	240	19 7/8	7 3/16	10 1/8	48.7	317.4	12.0	A	3
145F51	NS150	25	120	150	760	296	19 7/8	7 3/16	10 1/8	56.2	370.3	14.0	A	3

Figures are based on JIS/SAE specifications and reference only.

TERMINALS (Measurements in inches)

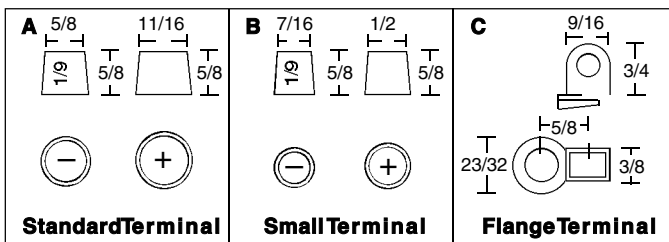

BATTERY LAYOUTS

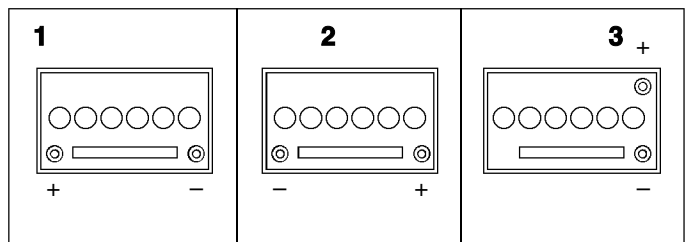

JAPANESE TRACTOR

MODEL	BATTERY	MODEL	BATTERY
HONDA EU3000is (Generator) EX4000 (Generator) EX4500 (Generator) H6522	YTX9-BS YB18L-A* YB18L-A* 55B24L(S)	KUBOTA (continued) B7200 F150S, F260S, F300S G1800, G1900 G3200, G4200, G5200 T1600 T1640 T1700X	46B24L(S) 46B24L(S) 55B24L(S) 40B19L(S) 40B19L(S) 55B24L(S) 40B19L(S)
ISEKI TU1400, TU1500 TU1600, TU1700 TU1900, TU2100 TX1000, TX1210 TX1300, TX1410 TX1500, TX1510	46B24R 46B24R 46B24R 46B24R 46B24R 46B24R	mitsubishi D1500, D2000 D2300, D2350 D2600, D2650 D3250 M1301 NS60 S630 ST1500, ST1510 ST1520, ST1550 ST2001, ST2300	46B24R 46B24R 46B24R 46B24R 46B24R 46B24R 46B24R 46B24R 46B24R 46B24R
KAWASAKI GD700-A52-700C GE5000-ASI 5000cc	YTX4L-BS 40B19L(S)	YANMAR YM122, YM146 YM155, YM165 YM180D, YM187	46B24R 40B19L 46B24R
KUBOTA ADT70S (Tiller) B1550, B1750 B20, B2150, B4200 B5100 B5200 B6100 B6200, B7100	YB14-A2* 55B24L(S) 55B24L(S) 40B19L(S) 55B24L(S) 46B24L(S) 55B24L(S)		

See 12 Volt Import Specialty Battery Specifications above.

MOTOCROSS

TOP25 BATTERIES

BatteryType	Sales Flow	Upgrade Option	PrimaryApplication
YTX14-BS	8.0%	YTX14H-BS	ATV
YTX5L-BS	7.4%		SCOOTER / Mini ATV
YB14A-A2	4.9%	YTX14AH-BS	ATV
YTX4L-BS	4.9%		SCOOTER / Mini ATV
YB16CL-B	4.6%	YTX20HL-BSPW	Watercraft
YTX9-BS	4.6%		ATV/Motorcycle
YTX7A-BS	4.5%		MOTORCYCLE / Mini ATV
YTX20L-BS	3.5%		MOTORCYCLE/WATERCRAFT
YTX12-BS	3.3%		ATV
YB14L-A2	2.3%	YTX14AHL-BS	Upgrade for L & G
YTX7L-BS	2.2%		MOTORCYCLE / Mini ATV
YTX20HL-BS	2.1%		MOTORCYCLE/WATERCRAFT
YT12B-BS	1.8%		MOTORCYCLE
YT7B-BS	1.7%		MOTORCYCLE
12N14-3A	1.7%	YB14L-A2 (YTX14AHL-BS)	LAWN and GARDEN
YT12A-BS	1.5%		MOTORCYCLE
Y50N18L-A3	1.5%	YTX24HL-BS	MOTORCYCLE / SNOWMOBILE
YB14-A2	1.4%	YTX14AH-BS	ATV
YIX30L	1.4%		MOTORCYCLE/ATV
YB12C-A	1.3%		ATV
Y50N18L-A	1.3%	YTX24HL-BS	SNOWMOBILE / L & G
YTZ10S	1.3%		MOTORCYCLE
YTX20CH-BS	1.3%		MOTORCYCLE / ATV
YTX14AH-BS	1.2%		MOTORCYCLE / SNOWMOBILE
YB30CL-B	1.2%		Watercraft
Market Coverage	<u>70.9%</u>		

* Note: Numbers are based upon the national average for Powersports for Battery Specialist.

ACTIVATING HIGH PERFORMANCE CONVENTIONAL (YB TYPE) AND CONVENTIONAL BATTERIES (6N & 12N TYPES)

STANDARD BATTERY (6N TYPES, 12N TYPES, AND YB TYPES)

PREPARATION FOR ACID FILLING

Take off sealing tube (usually red color attached to vent) and remove filling plugs – right before filling with electrolyte. Replace the short sealing tube pulled off from battery vent elbow with a long exhaust tube.

FILLING ELECTROLYTE (ACID)

Fill battery with electrolyte (dilute sulfuric acid) with a specific gravity of 1.265 at 68°F. Fill to UPPER LEVEL as indicated on battery. Electrolyte should have a

temperature between 60 and 86°F before filling. Leave battery standing at least 30 min. after filling. Acid level may have fallen during standing. Refill acid to UPPER LEVEL before starting charge.

CHARGING

Place battery on charge for 3 to 5 hours at approximately the current equivalent to 1/10th of its rated capacity. The battery can take a quick charge at a higher current up to the maximum current of 3/10th of capacity. However, a quick charge can only be taken by surface area of the battery plates, while lower current can charge the battery uniformly. If electrolyte level has fallen after charging, fill with clean

drinking water to UPPER LEVEL. After water is added, continue charging 1 to 2 hours to mix water with acid. After charging, replace filling plugs firmly, wash off acid spillage with water and dry battery case. Make sure the battery terminals are completely clean of any acid substances.

Do not use sealed tube (red tube) once battery is filled with acid. Using sealed tube (red tube) after acid filling may cause explosion.

BATTERY MAINTENANCE FOR 6N, 12N and YB TYPES

Periodic battery maintenance should be performed whether or not a starting problem has occurred. The following procedures will help prevent premature battery failure:

1. CHECK ELECTROLYTE LEVEL (not required for sealed maintenance free batteries). If the electrolyte level is below the tops of the plates in any cell (or the lower level line) refill with clean drinking or distilled water to upper level line.

NOTE: Low electrolyte level may be a malfunction in the charging system.

2. Keep the battery clean of all acid spillage and dirt, especially around the terminal area.

3. Keep the exhaust tube free of any kinks or dirt build-up.

4. If the vehicle is not used frequently the battery will require additional recharging. Specific charging rates or times vary because of the following:

(A) Battery's electrical capacity

(B) Temperature of the electrolyte

(C) Battery state of charge at the start of charging

(D) Battery age and condition

(E) Type of charger

5. Check the specific gravity of acid or the voltage of the battery to make sure it is at a 100% charged condition. If not, additional charging is required. See charts below for battery test readings using either a hydrometer or a voltmeter.

SPECIFIC GRAVITY READING USING A HYDROMETER				
STATE OF CHARGE	ELECTROLYTE TEMPERATURE			
	80°F		40°F	
	YB TYPES	6N & 12N TYPES	YB TYPES	6N & 12N TYPES
100%	1.275	1.265	1.290	1.280
75%	1.225	1.215	1.240	1.230
50%	1.175	1.165	1.190	1.180
25%	1.135	1.125	1.150	1.140

BATTERY VOLTAGE READING USING A VOLTMETER			
STATE OF CHARGE	YT & YI TYPES	YB TYPES	6N* & 12N TYPES
100%	13.0 Volts	12.7 Volts	12.6 Volts
75%	12.8	12.5	12.4
50%	12.5	12.2	12.1
25%	12.2	12.0	11.9
0%	12.0 or less	11.9 or less	11.8 or less

* 6N types divide voltage in half.

NOTE: All High Performance Conventional (YB Type) and Sealed (YT and YI Types) Batteries contain a special chemical, **SULF DEFENSE™**, that has been added to reduce sulfate crystal deposits (which eventually prevent the battery from accepting a charge).

SULF DEFENSE™ is a white powder chemical that may be visible before the battery is activated, but dissolves once electrolyte is added.

If the battery contains **SULF DEFENSE™**, and has not been in use for a long period of time, extended recharging time is required.

ACTIVATION AND CHARGING SEALED MAINTENANCE FREE (AGM) BATTERIES (YT & YI TYPES)

1. Place the battery on a level surface. Battery must be out of the vehicle.

2. Remove electrolyte container from vinyl bag. Pull off the strip of caps. **Put the strip aside – you'll use this later as the battery sealing plug.** Use only the dedicated container that comes with the battery. It contains the proper amount of electrolyte for your specific model – important to service life and operation. Do not pierce or otherwise open the sealed cells of the electrolyte container. Do not attempt to separate individual cells.

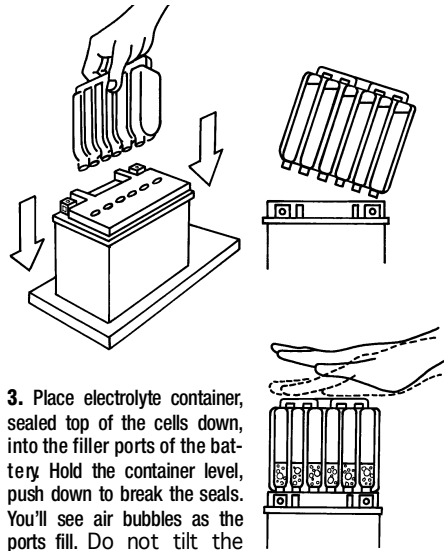
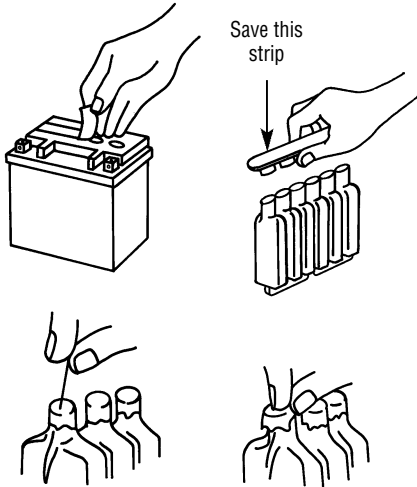

3. Place electrolyte container, sealed top of the cells down, into the filler ports of the battery. Hold the container level, push down to break the seals. You'll see air bubbles as the ports fill. Do not tilt the electrolyte container.

4. Check the electrolyte flow. Keep the container in place for 20 minutes or longer until it empties completely. If no air bubbles are coming up from the filler ports, or if container cells haven't emptied completely, tap the container a few times. Don't remove the container from the battery until it's empty. The battery requires all the electrolyte from the container for proper operation. Make sure the electrolyte container empties

completely.

5. Remove the container. For batteries 3 - 12 AH, let stand for at least 30 minutes. For batteries greater than 12 AH, allow the battery to stand a minimum of 1 HOUR. This allows the electrolyte to permeate

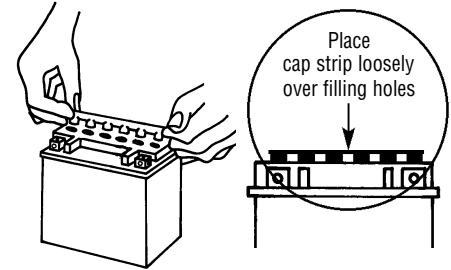

6. Newly activated sealed maintenance free batteries require an initial charge. After adding electrolyte, a new battery is approximately 80% charged. Place cap strip loosely over the filling holes as shown in drawing above. Immediately charge your battery after the "stand" period, to bring it to a full state of charge. (See "When a Battery Needs an Initial Charge" chart below)

After charging is completed, press down firmly with both hands to seat the caps (don't pound or hammer).

The battery is sealed. There is no need to remove the strip of caps or add

WHEN A BATTERY NEEDS AN INITIAL CHARGE

Condition Requiring Initial Charge	At low temperatures (lower than 0°C or 32°F)	Battery has been stored under high temperature and humidity.	Aluminum seal sheet has been removed or broken (When you did not hear air-sucking sound as you removed the sheet).	Battery older than 2 years or more after manufacture.
Charging Method	Charge time using standard current 2 - 3 hours	Charge time using standard current 15 - 20 hours		

YTX20L-BS CHARGING METHOD

- THIS IS A SEALED BATTERY; THE SEALING CAPS SHOULD BE CONSIDERED PERMANENT.
- DO NOT REMOVE THE CAPS TO ADD WATER OR TO CHARGE THE BATTERY; CHARGE AT 12V AT THE AMPERAGE AND HOURS STATED BELOW.

STD.: 1.8A x 5~10h or QUICK: 9.0A x 1.0h

CHARGING INSTRUCTIONS FOR NEWLY ACTIVATED SEALED MAINTENANCE FREE (AGM) BATTERIES

These batteries are a sealed VRLA construction – which means:

NEVER REMOVE THE SEALING STRIP AFTER CHARGING IS COMPLETED!

If the battery gets very hot to the touch, cease charging and allow battery to cool down.

CHECK VOLTAGE USING A VOLTMETER. READINGS FOR A CHARGED, NEWLY ACTIVATED BATTERY SHOULD BE 12.8V OR HIGHER AFTER FOR A TWO HOUR REST PERIOD FOLLOWING CHARGE. (REST REQUIRED TO LOSE SURFACE CHARGE.)

CAUTION: ALWAYS WEAR PROTECTIVE EYE GEAR WHEN WORKING AROUND BATTERIES

